

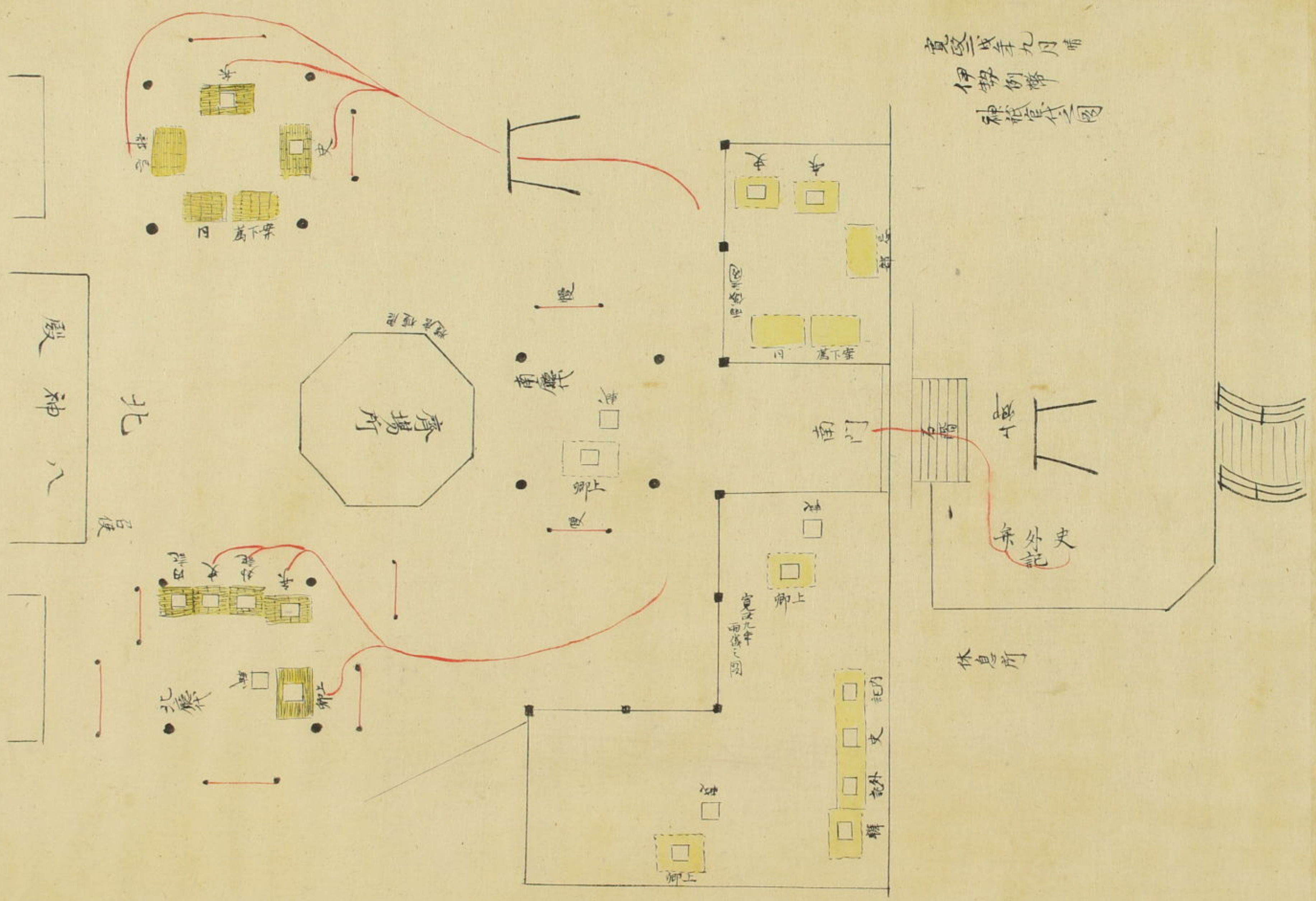

殿内御装束并調度圖 秘



寛政戊午九月  
伊勢御幣  
神祇倉代圖

御外史  
休息所

御神八

北

齋場所

南門

休息所





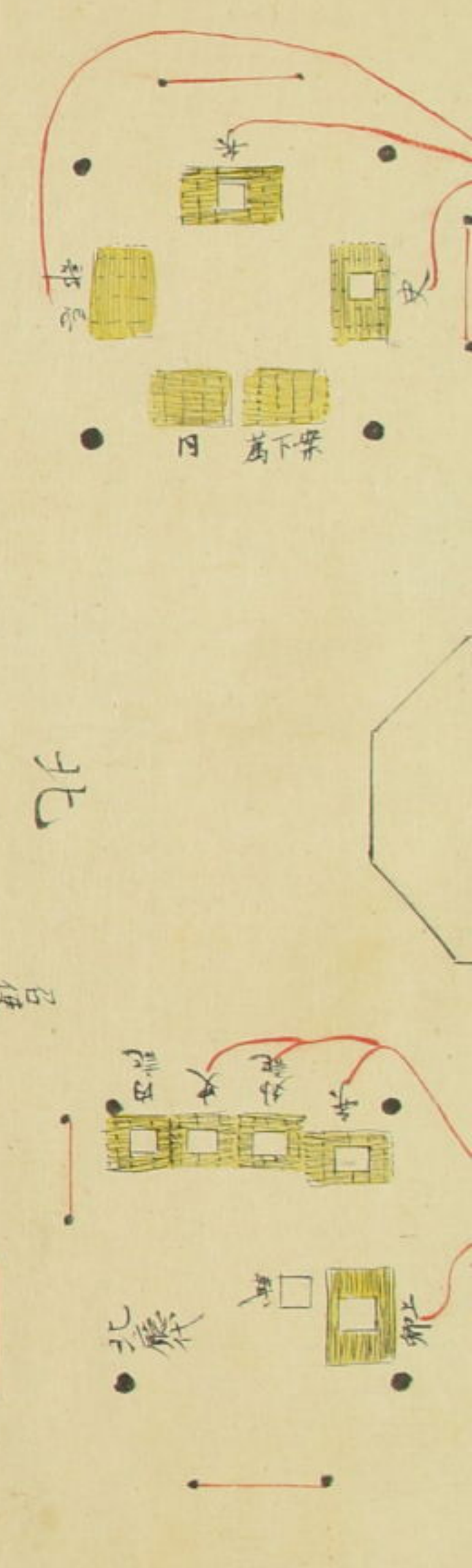

立后紫宸殿御注家束

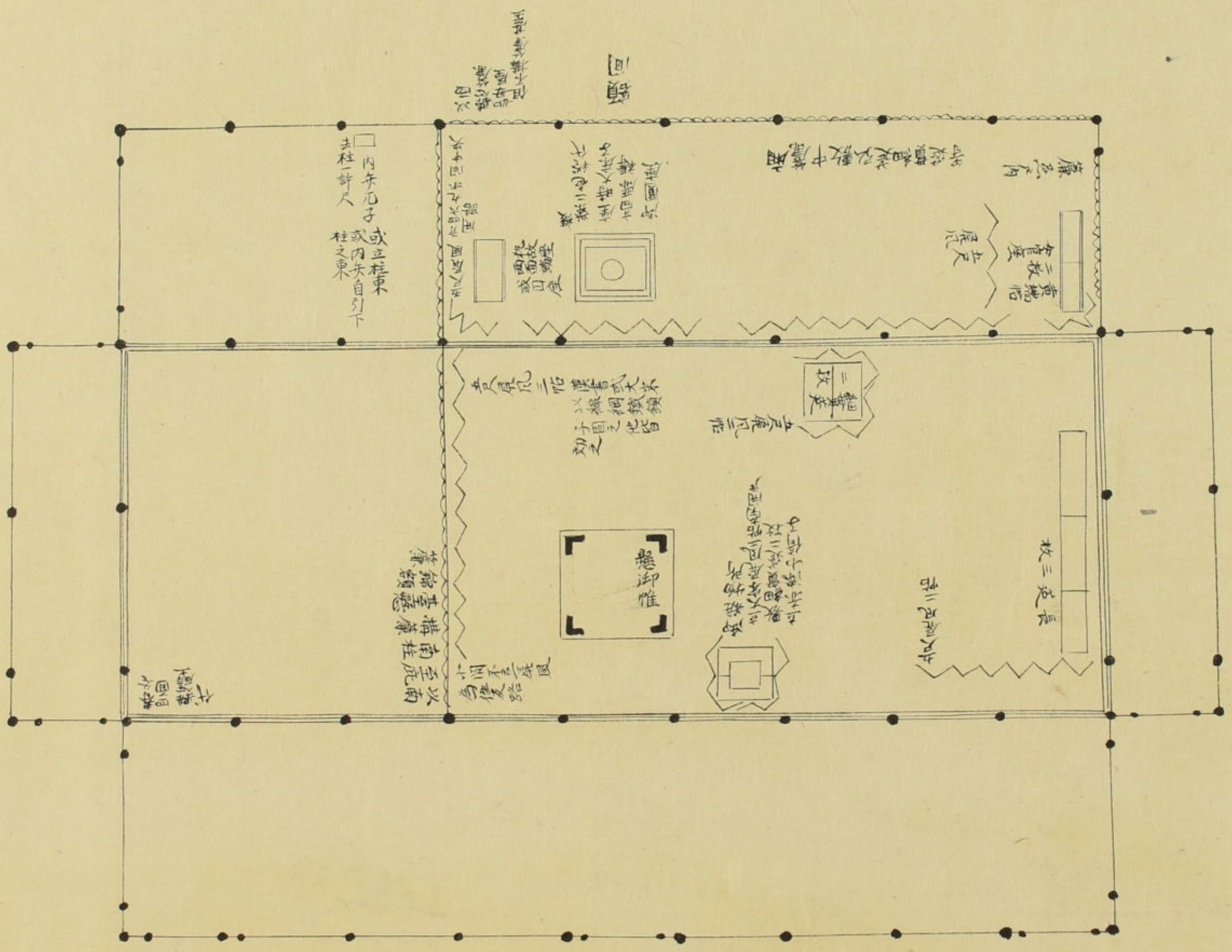

官司除月御前儀御注家束  
 柳雪易枚女叙位并回記





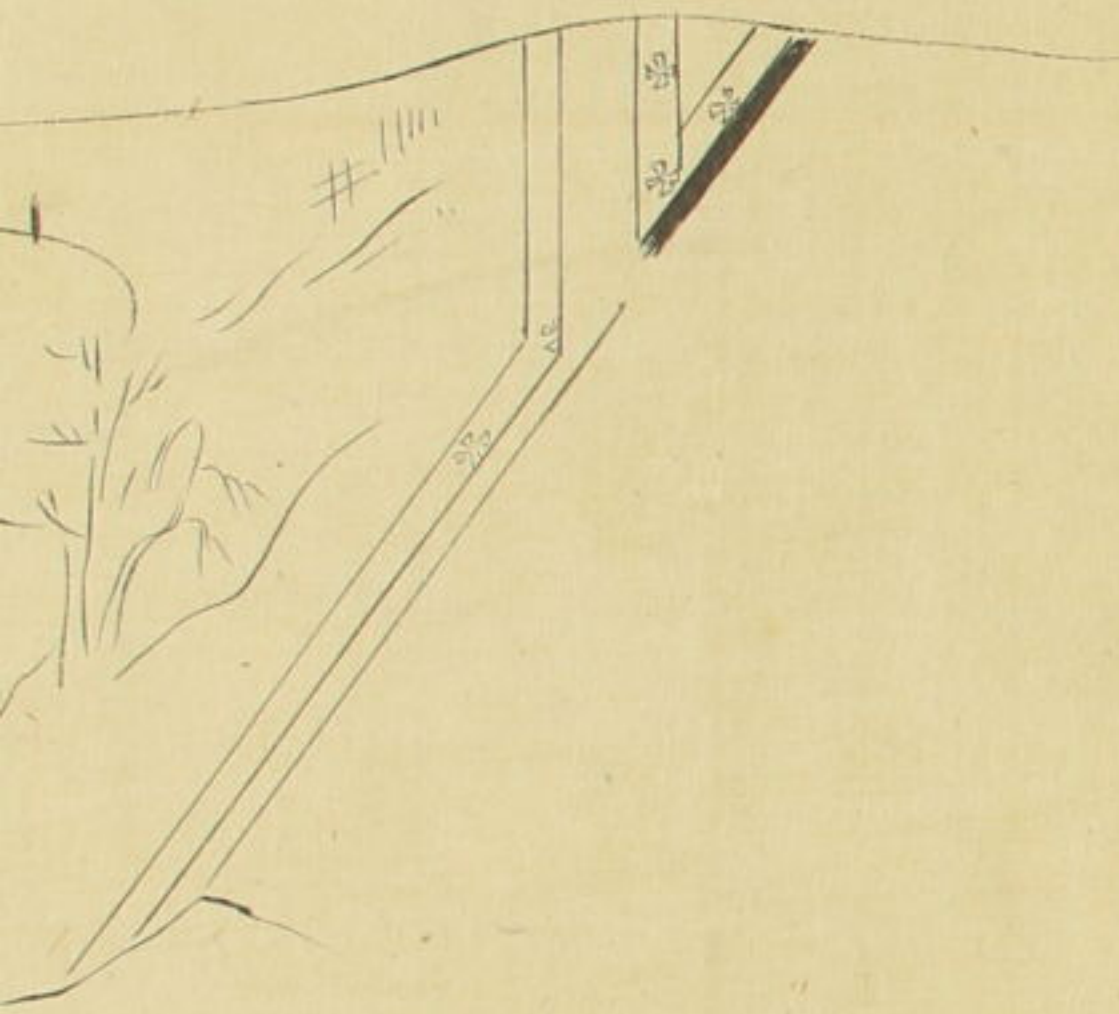

巨障子回

仔細繪卷

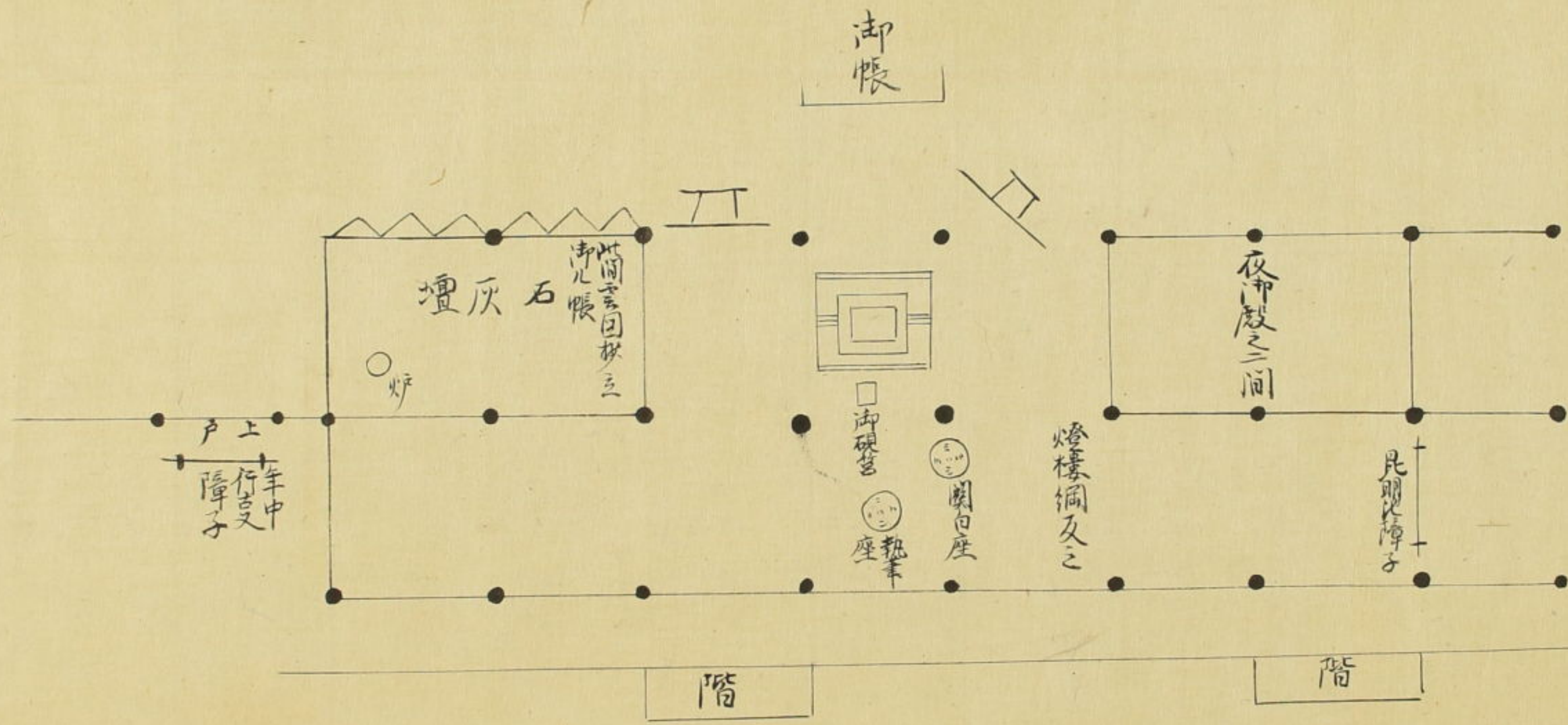

官司除月御前儀御帳東

掘雲男抄女叙位并回記

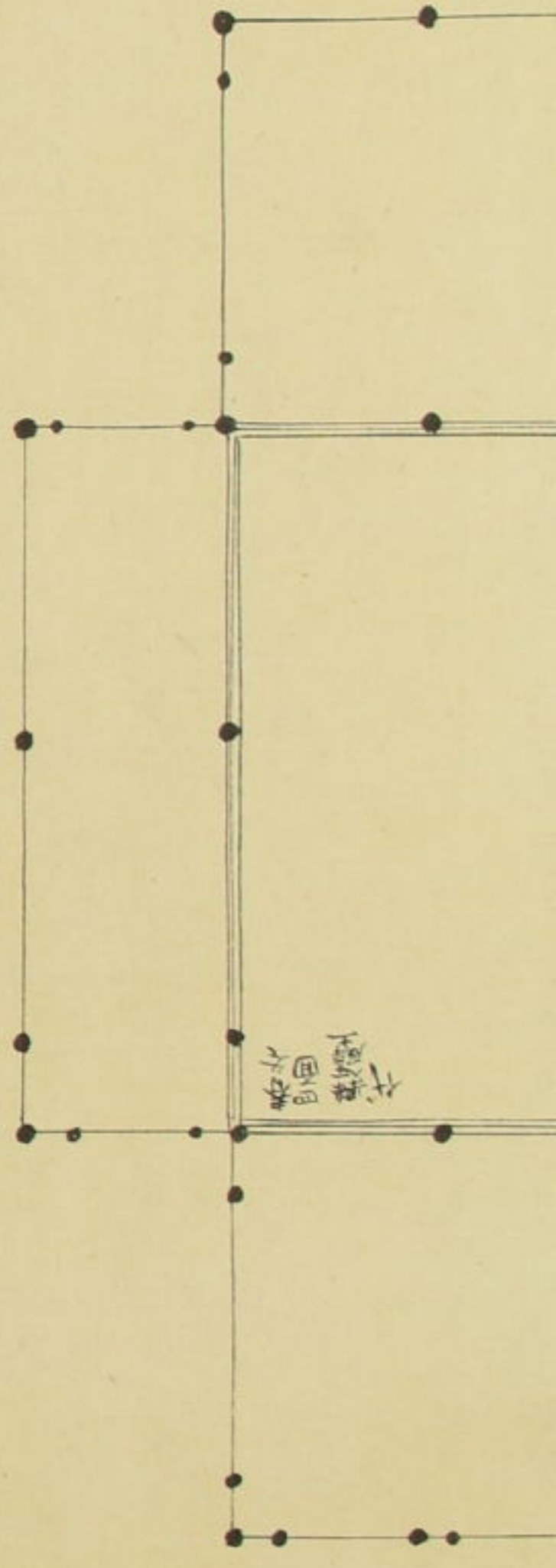



高御座之圖

貞享四年四月廿八日  
御即位之料也

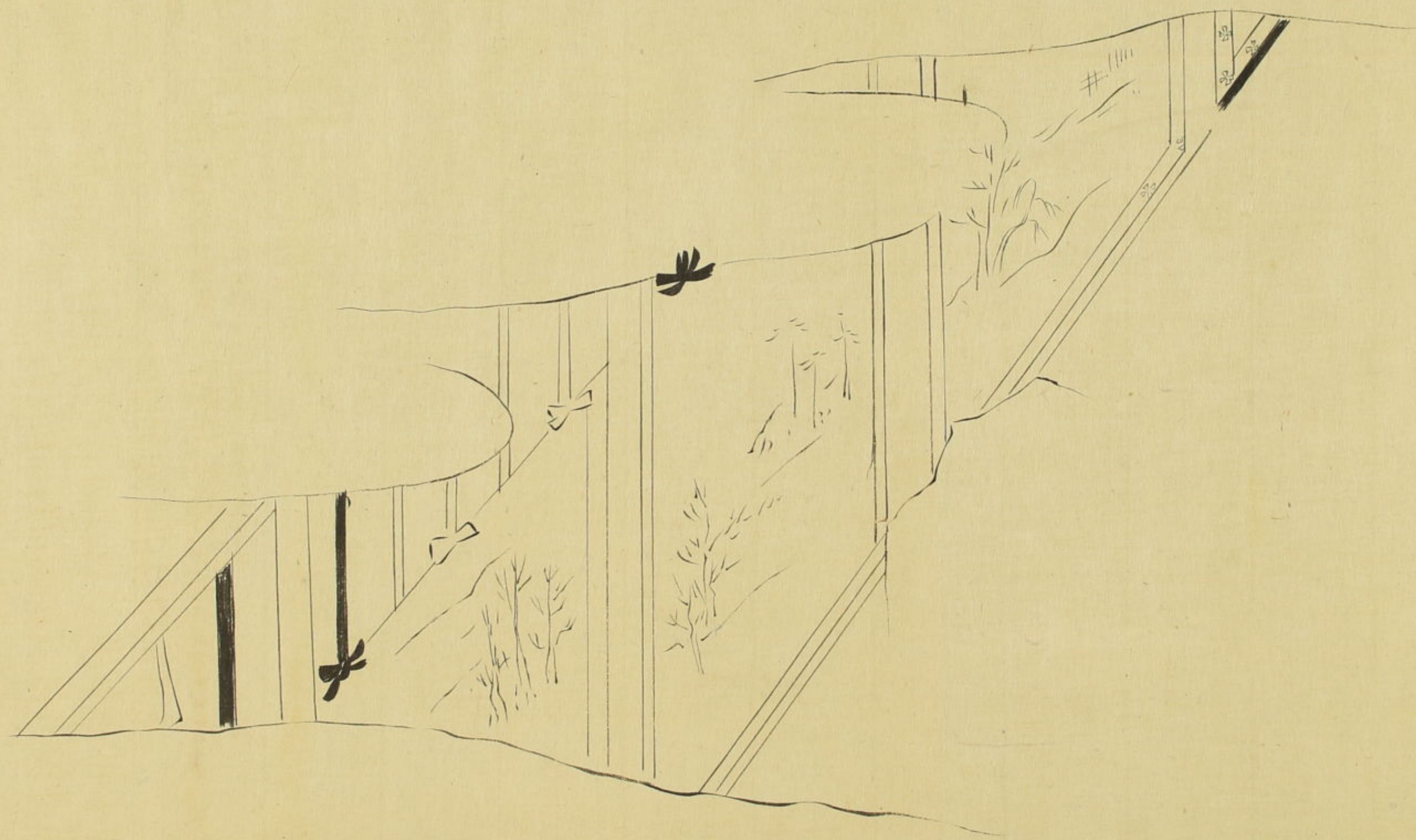

巨障子

伊内

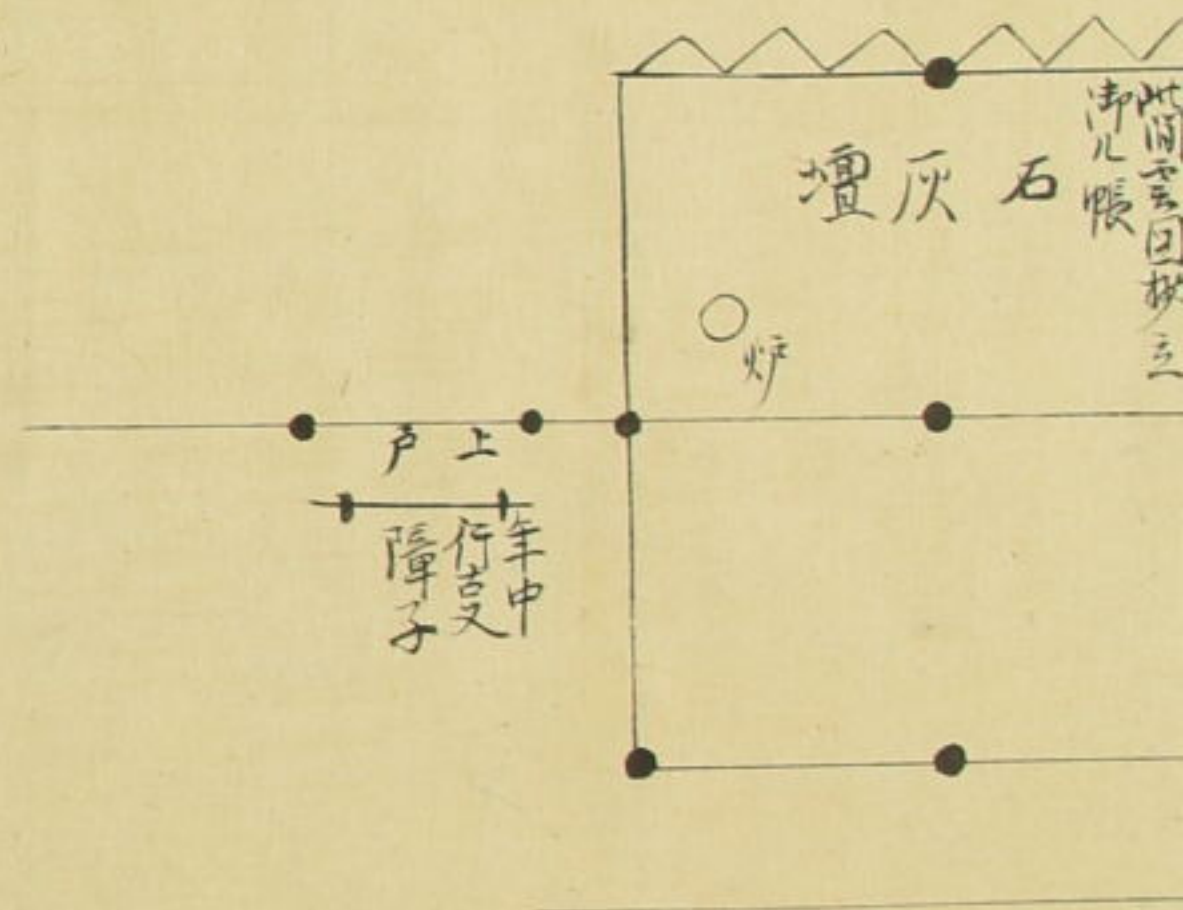



赤坂小御子

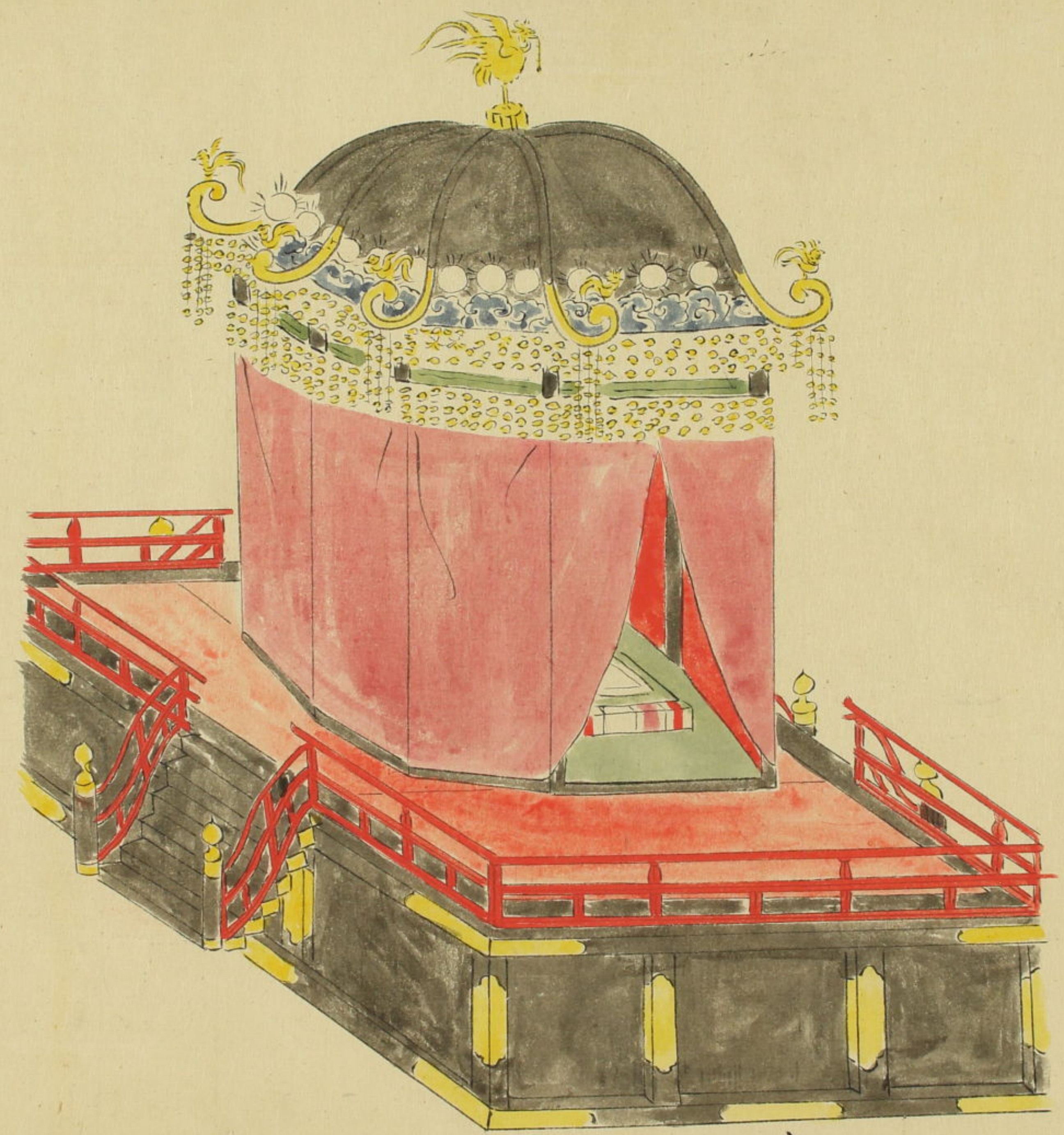
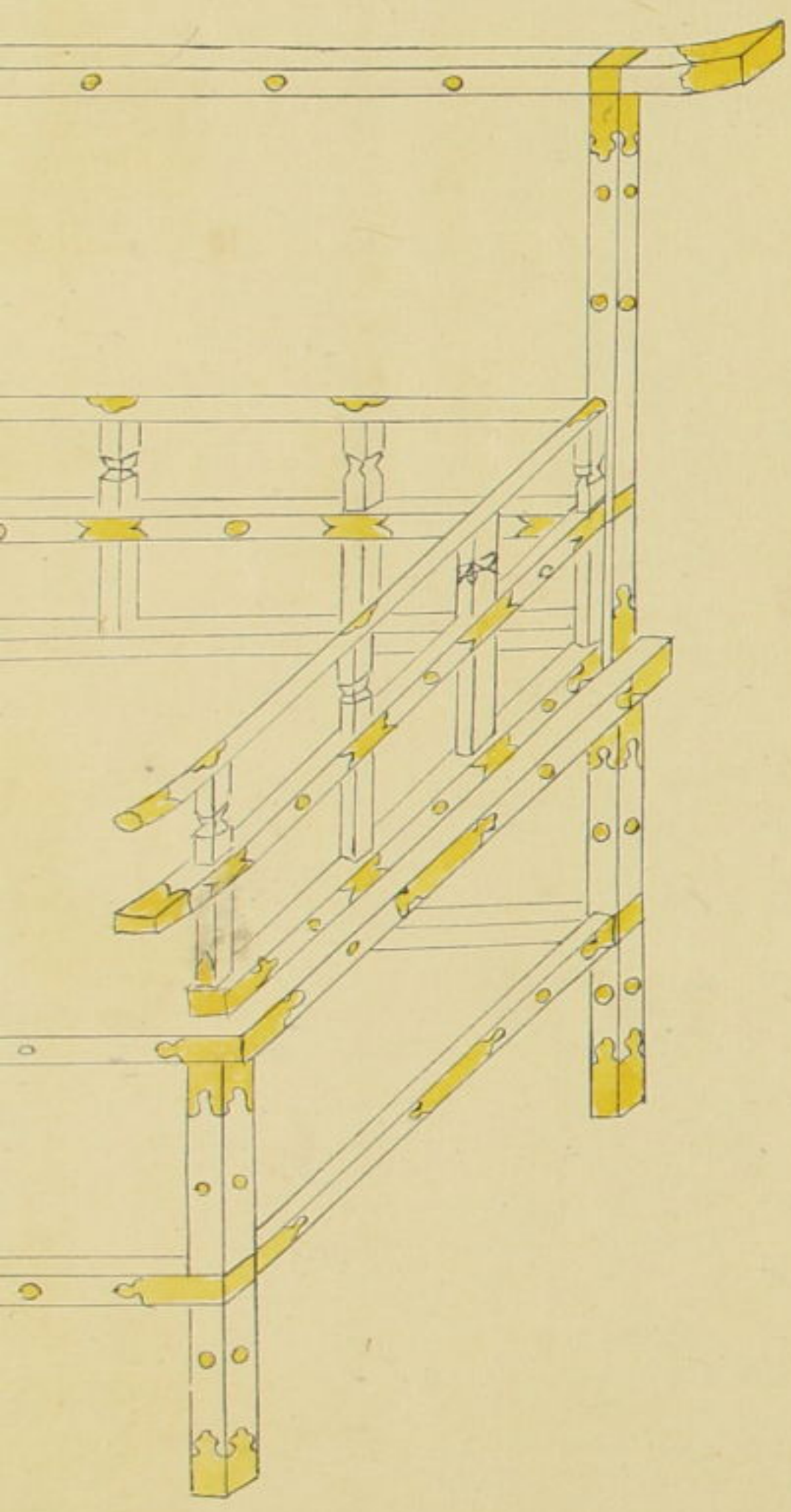

南

高御座之圖

貞享四年四月廿八日  
御即位之料也

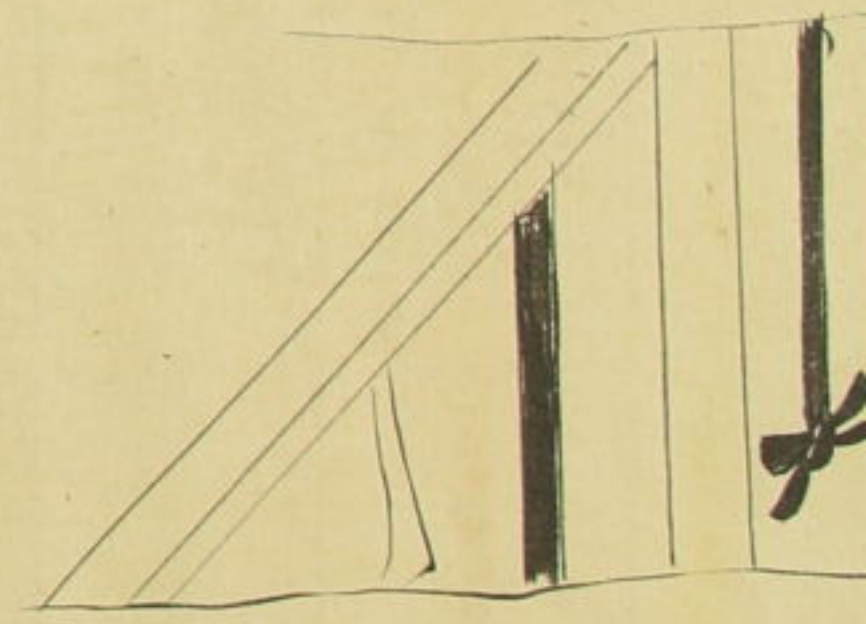



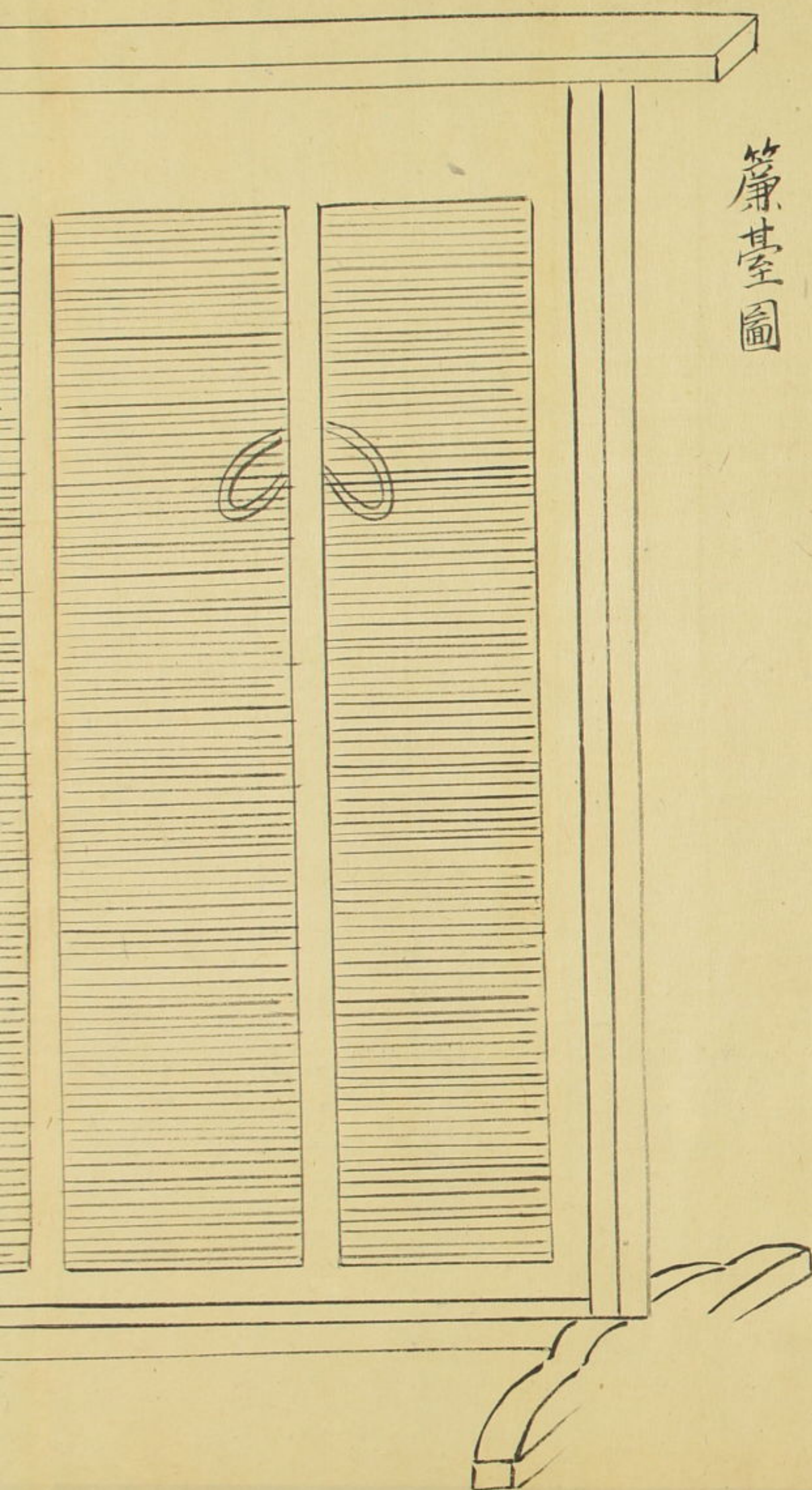

簾其室圖



御所子漆俵圖

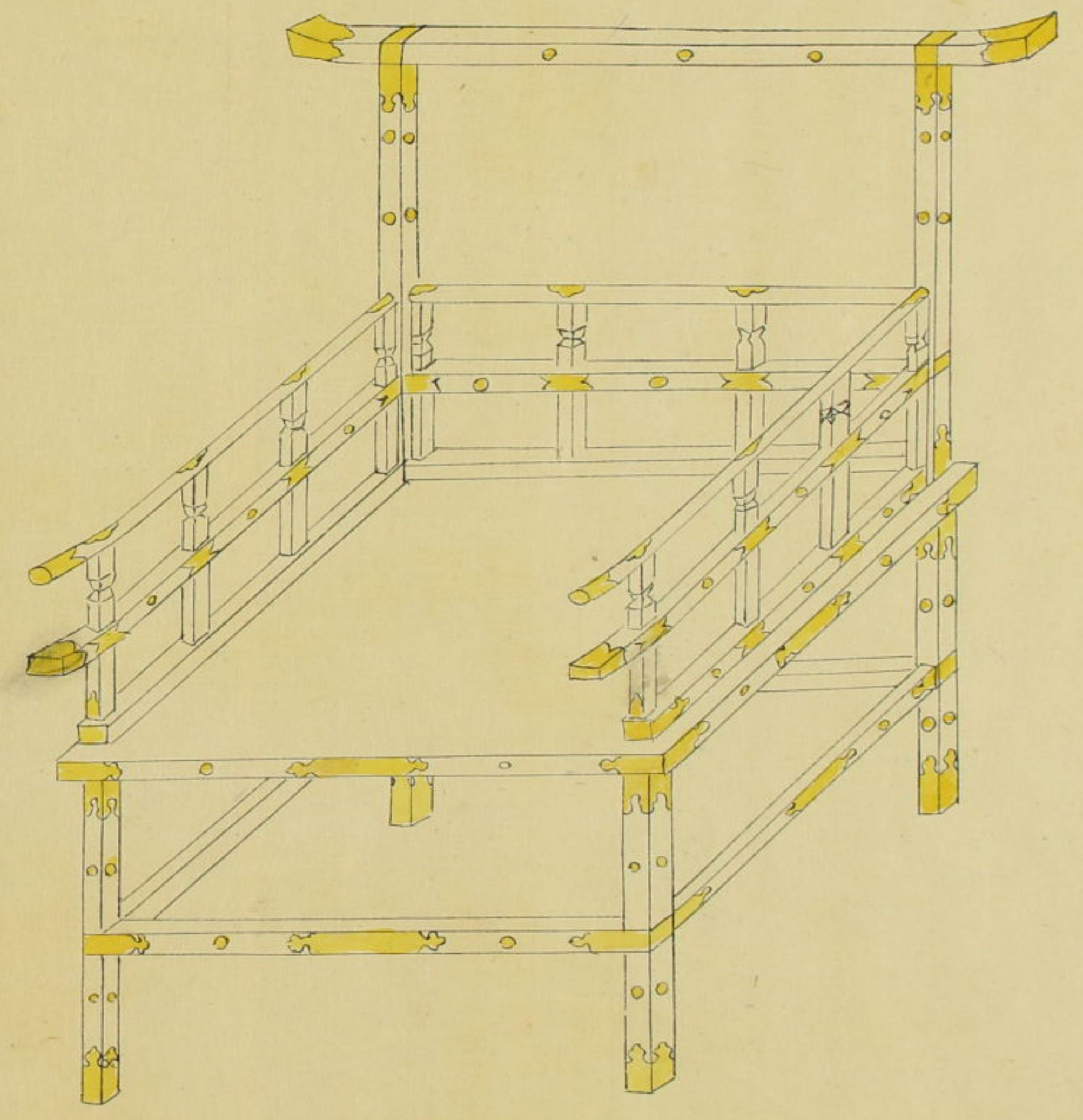

赤漆御所子



簾基圖

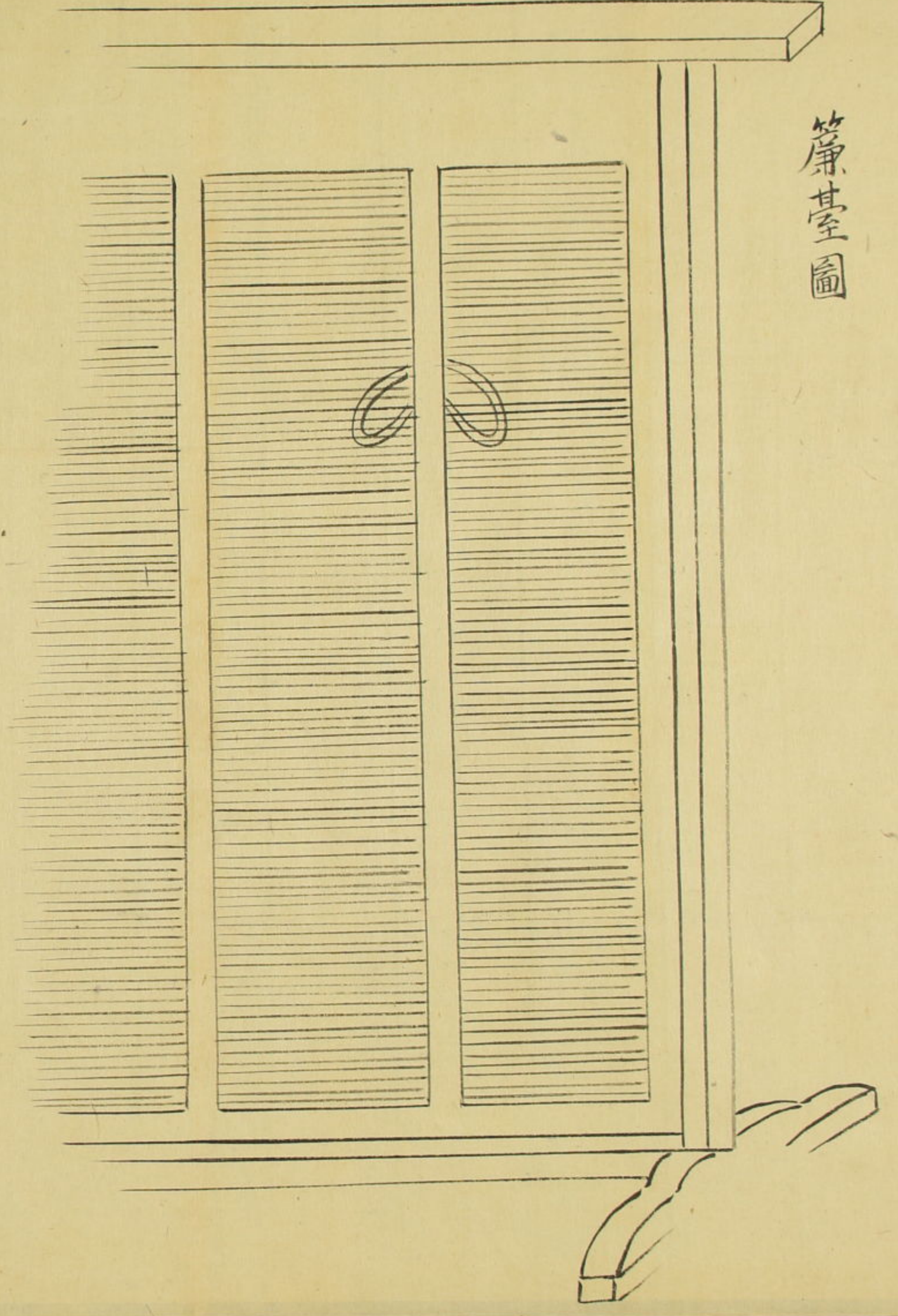

簾臺圖

若多不宜六如朱引可有橫貫死

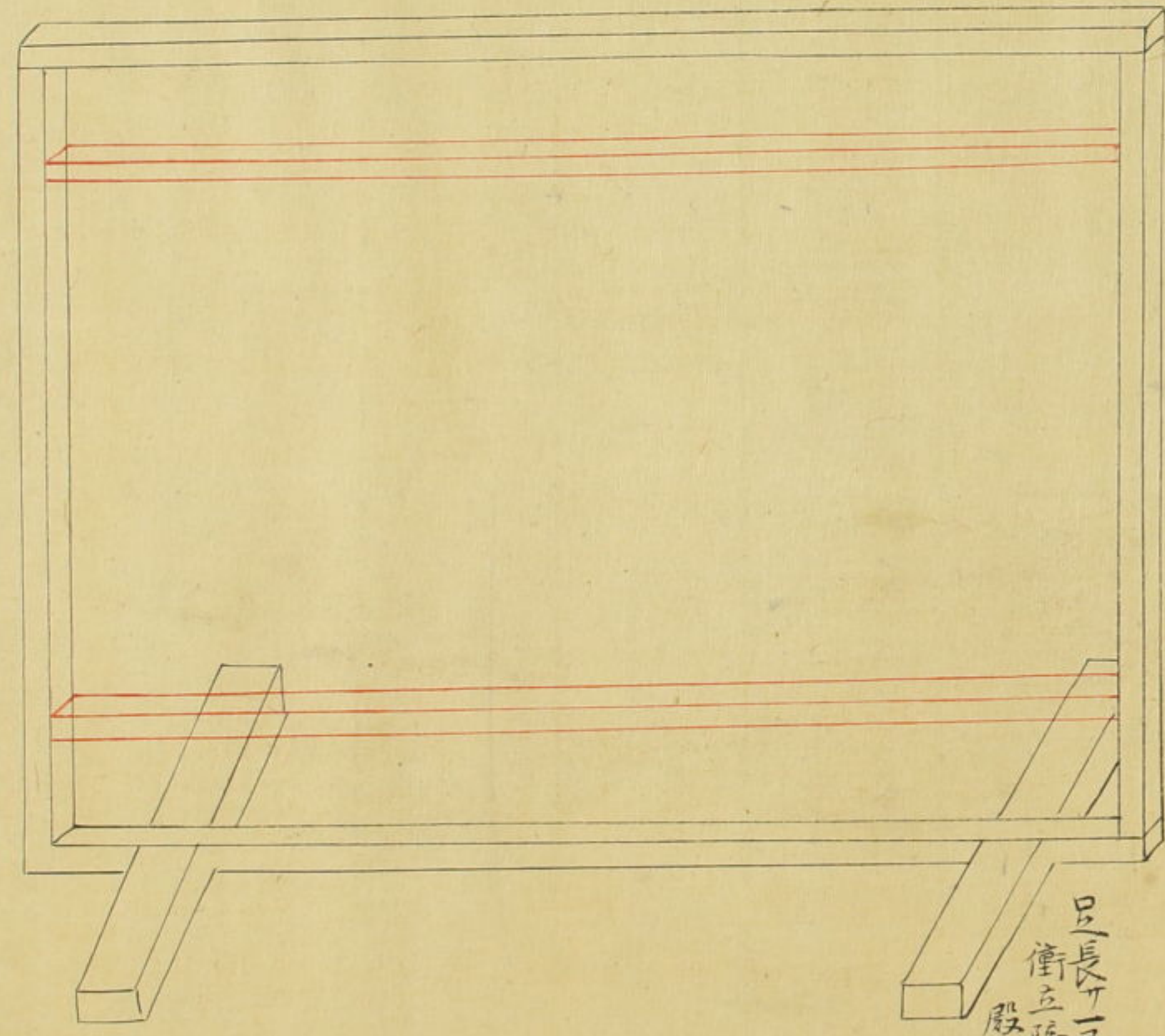

足長一尺許批  
衝立障子并  
殿楹寸法  
注之

南殿庇 高七尺 幅一丈 二基 高幅等批圖障子 寸法已下同之

同母屋 高幅同上 三基

同小間 高七尺 幅五尺 一基



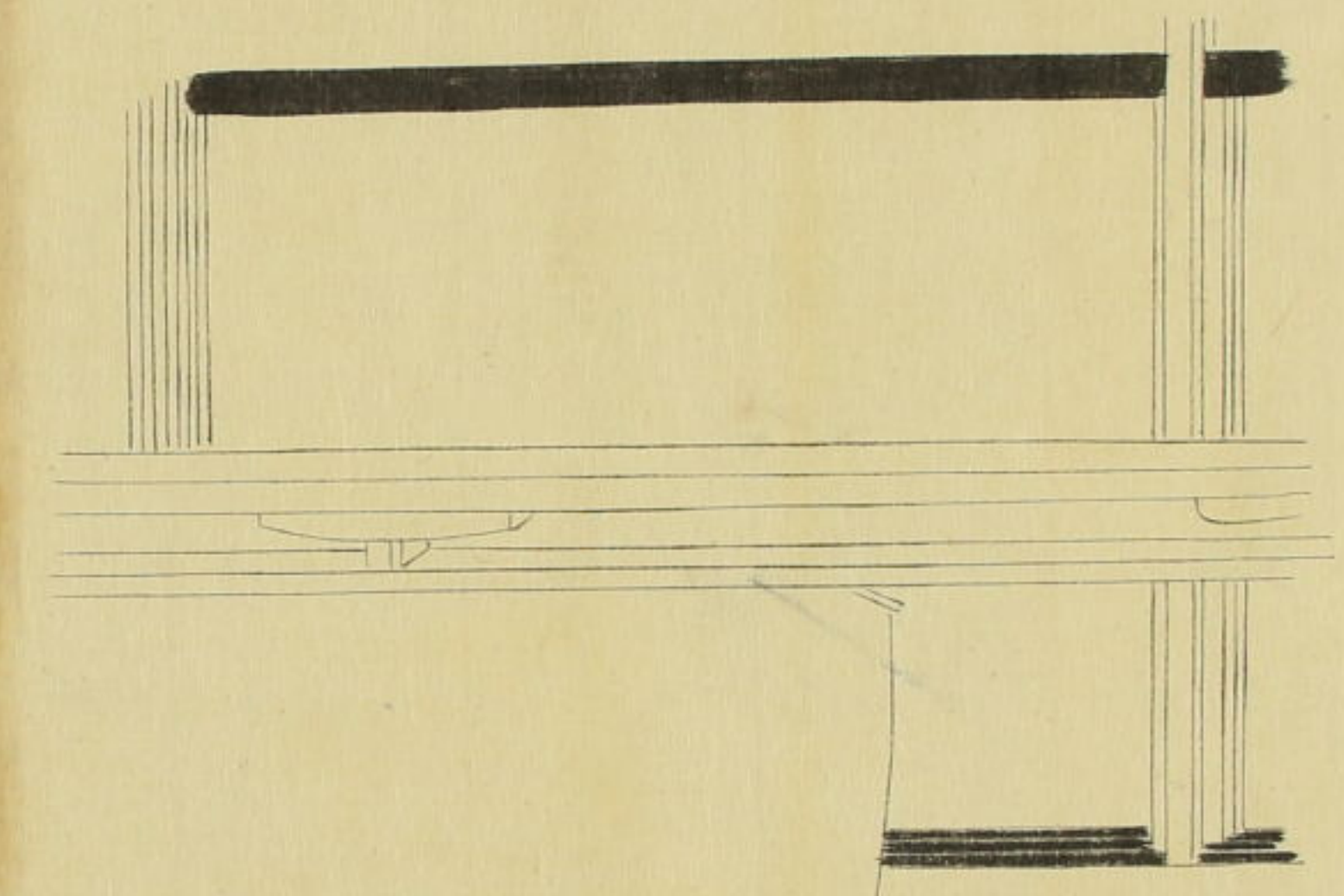

帳代長坤墨添

権現輪沓

同母屋 高幅同上 三基  
 同小間 高七尺 幅五尺 一基



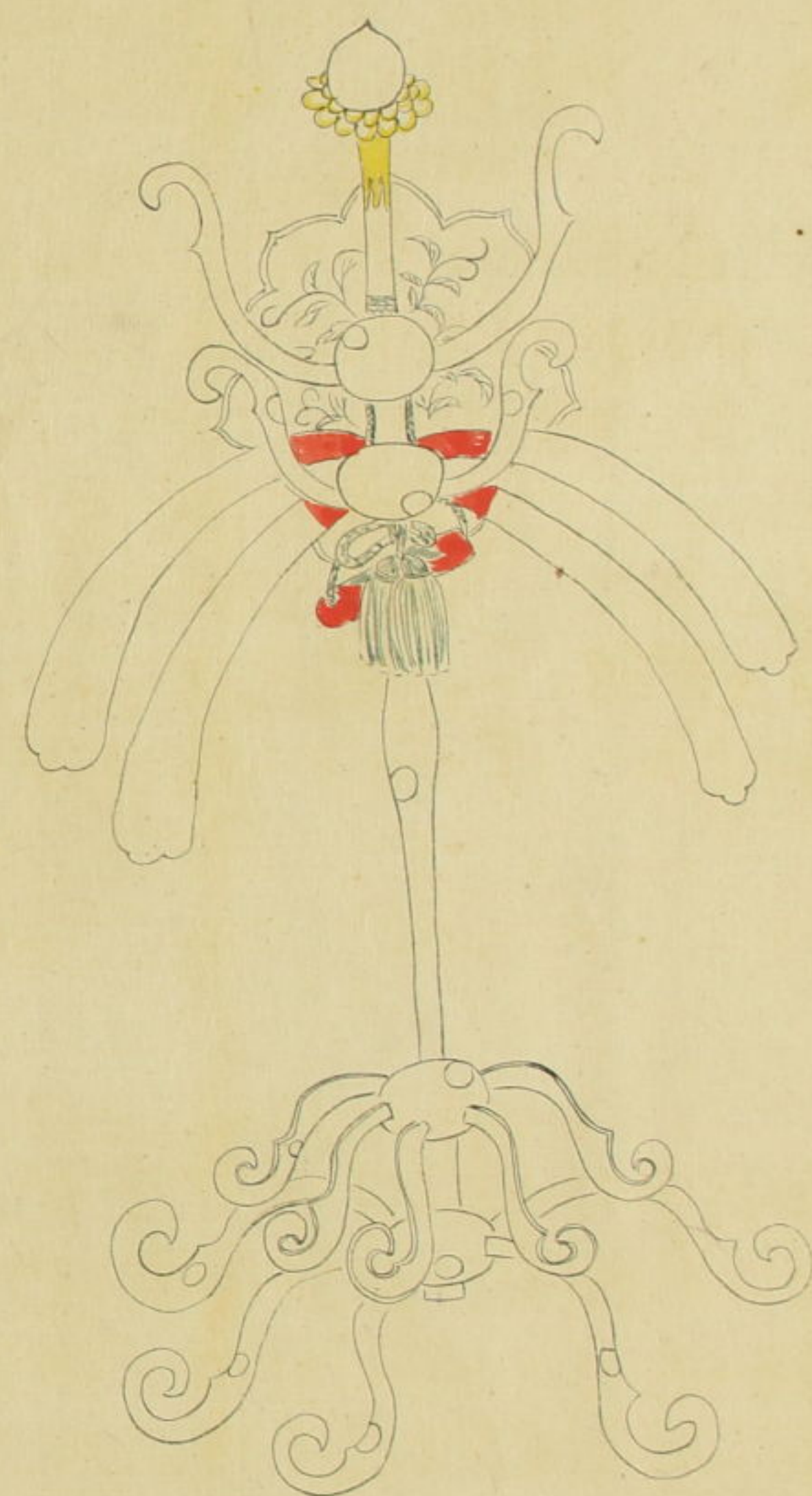
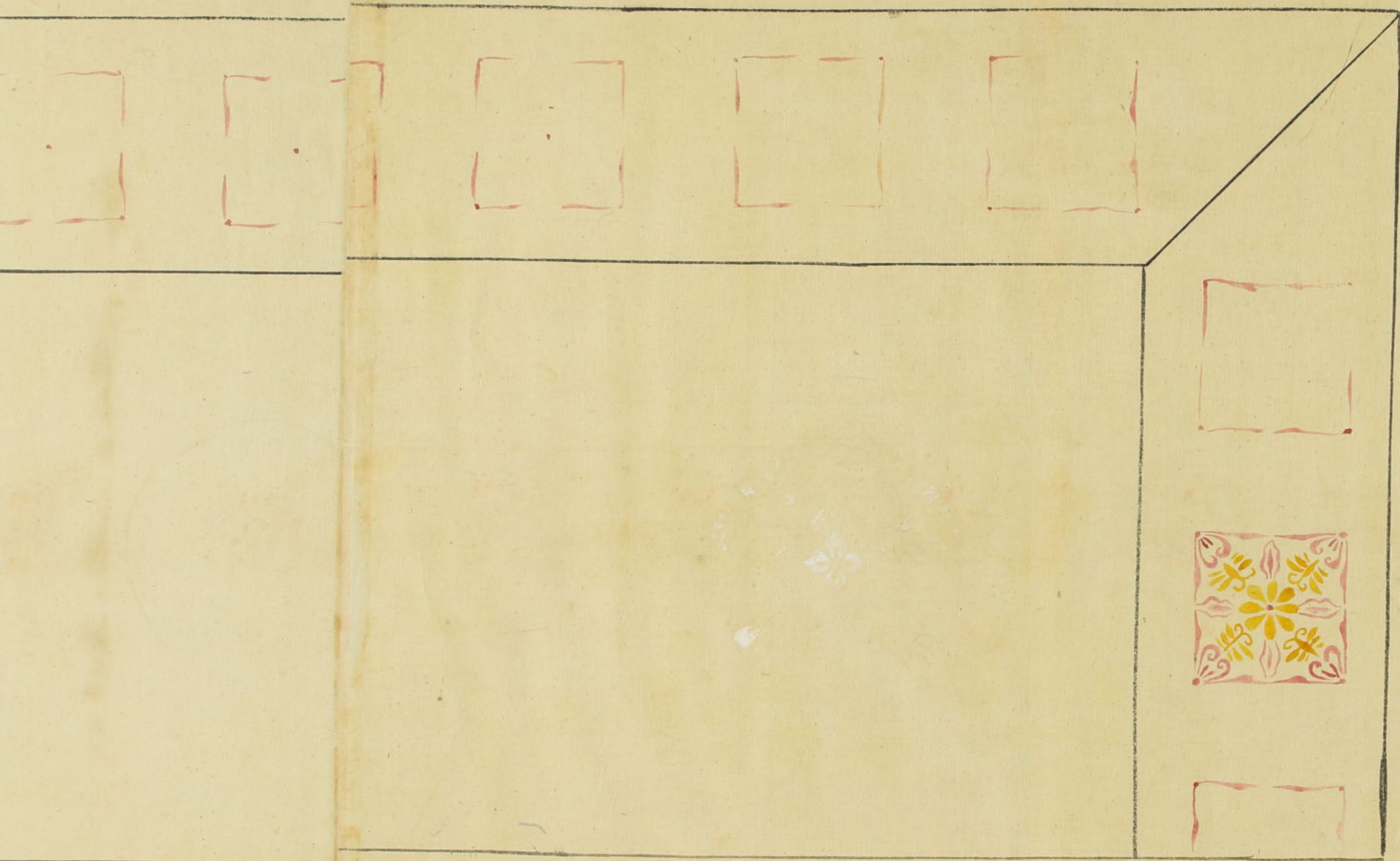



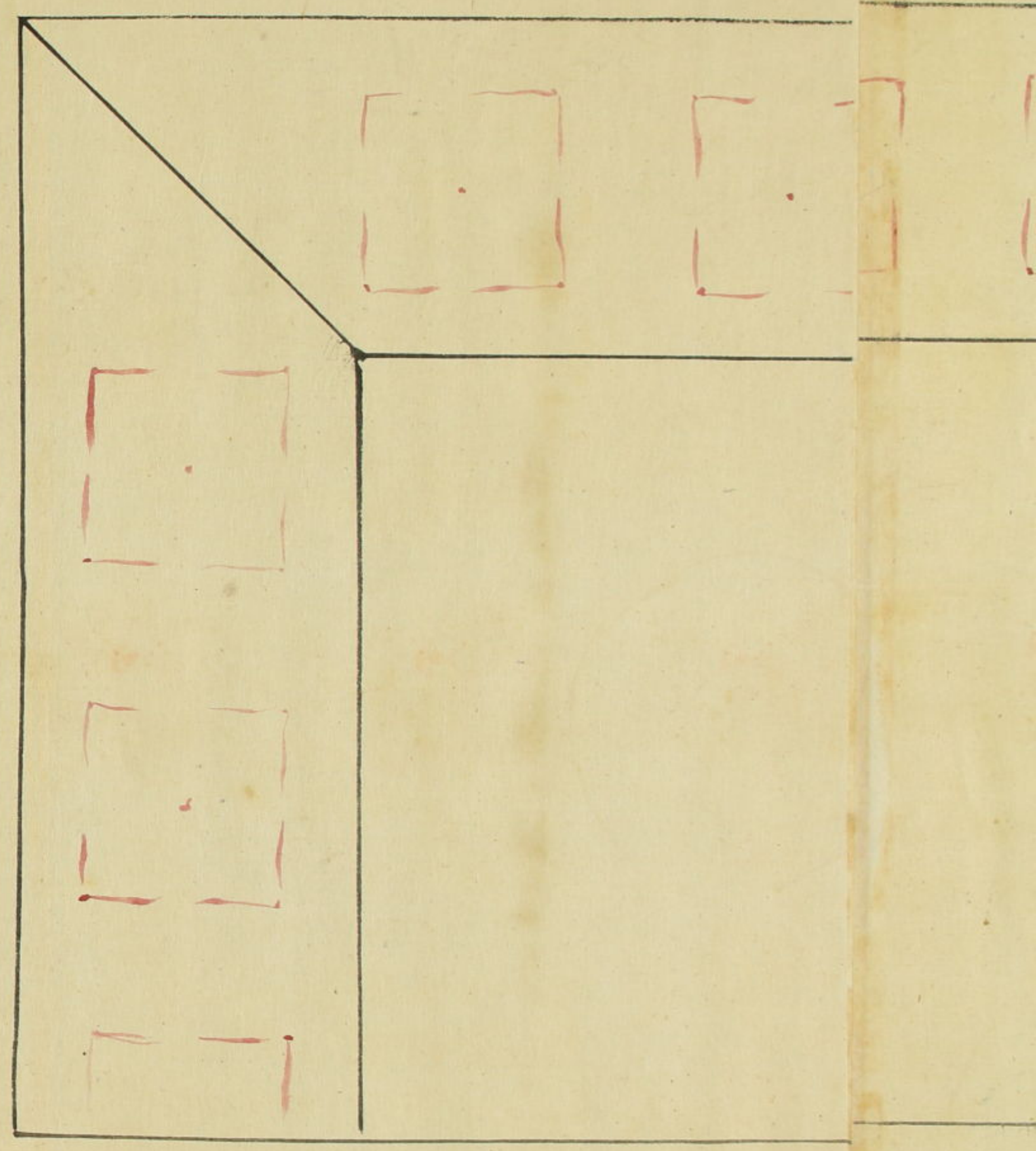
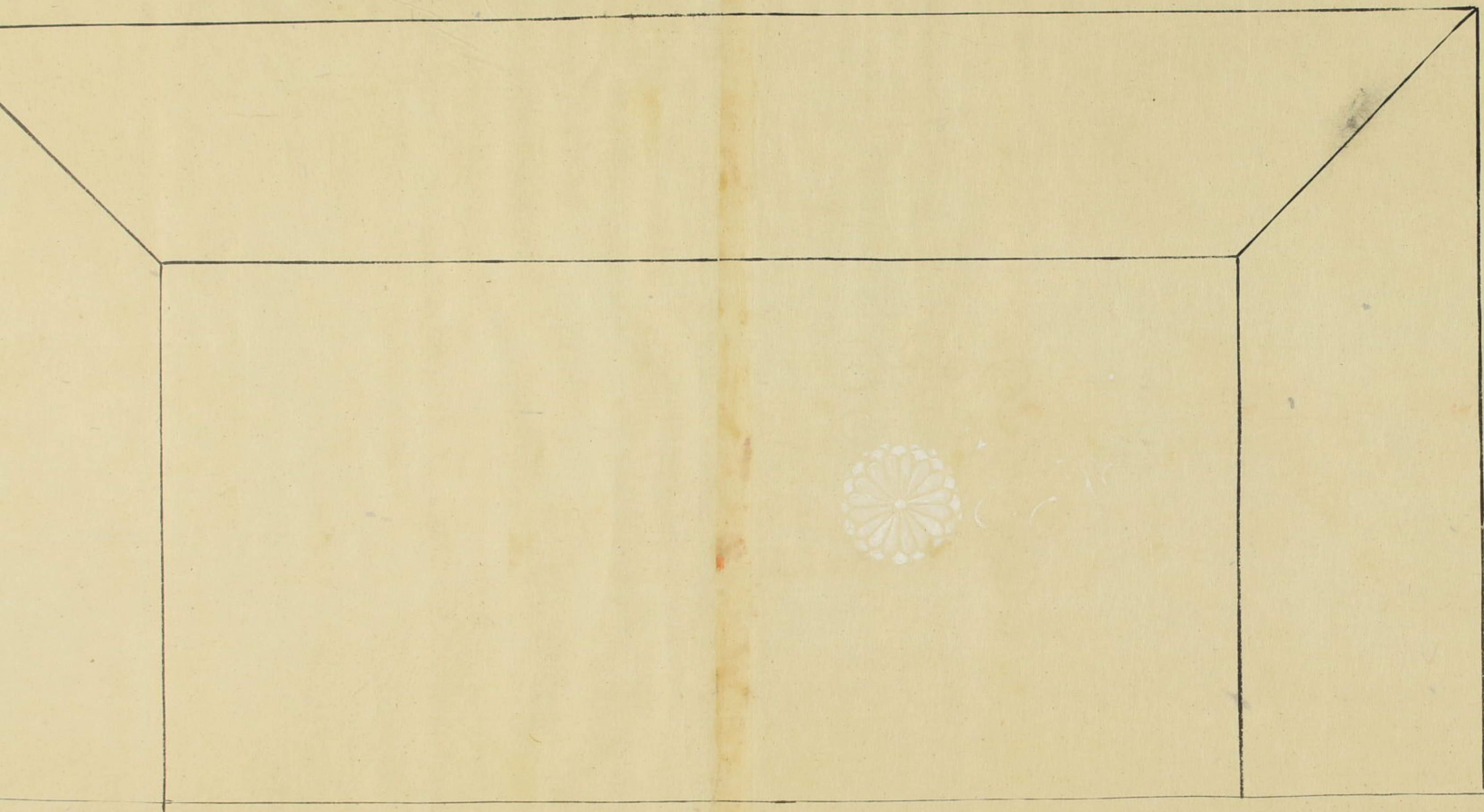



懸南



銀朱漆

以銀朱覆  
漆面亦銀  
漆文之極



銀朱漆



銀朱漆

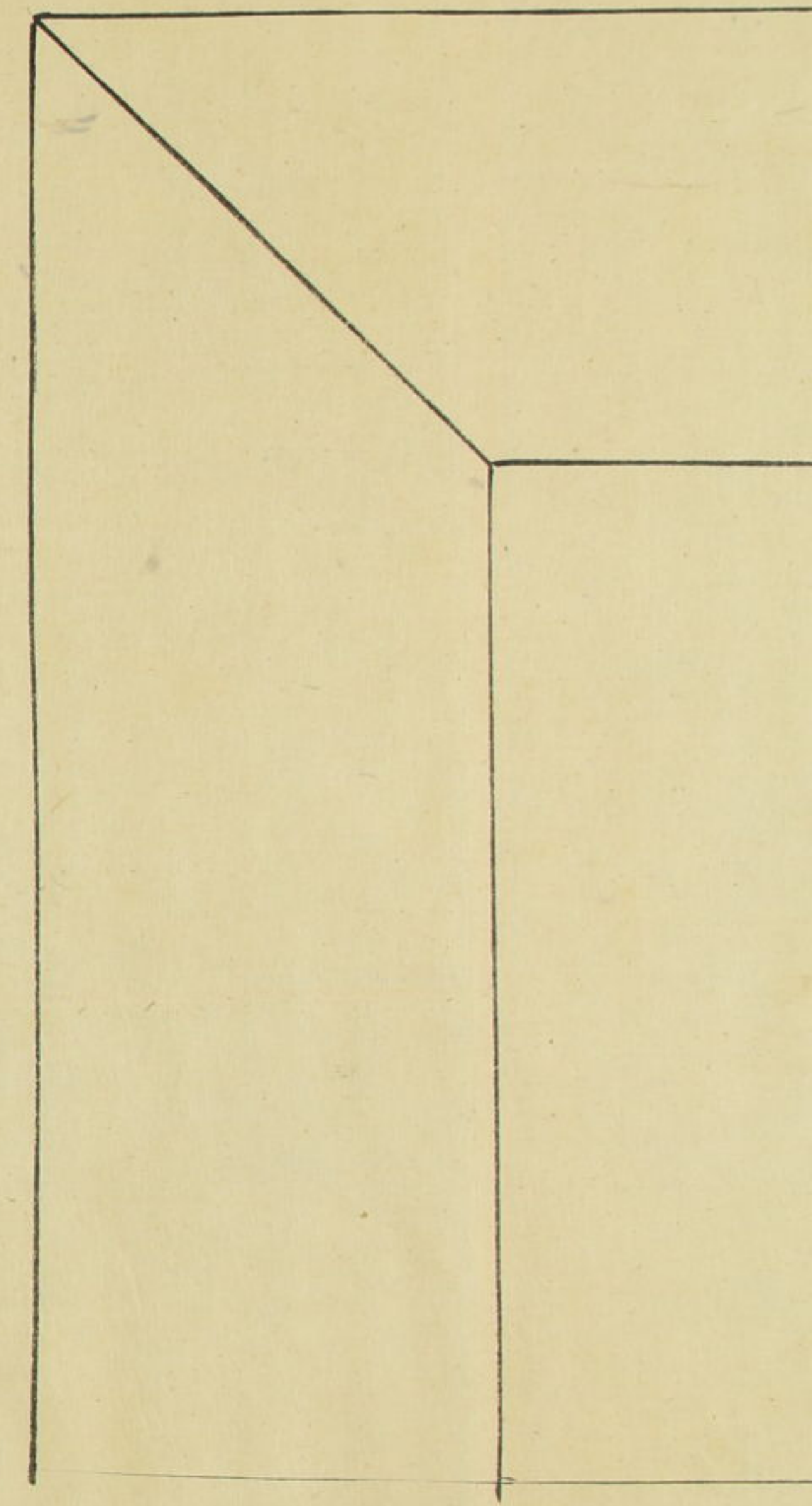



同本目

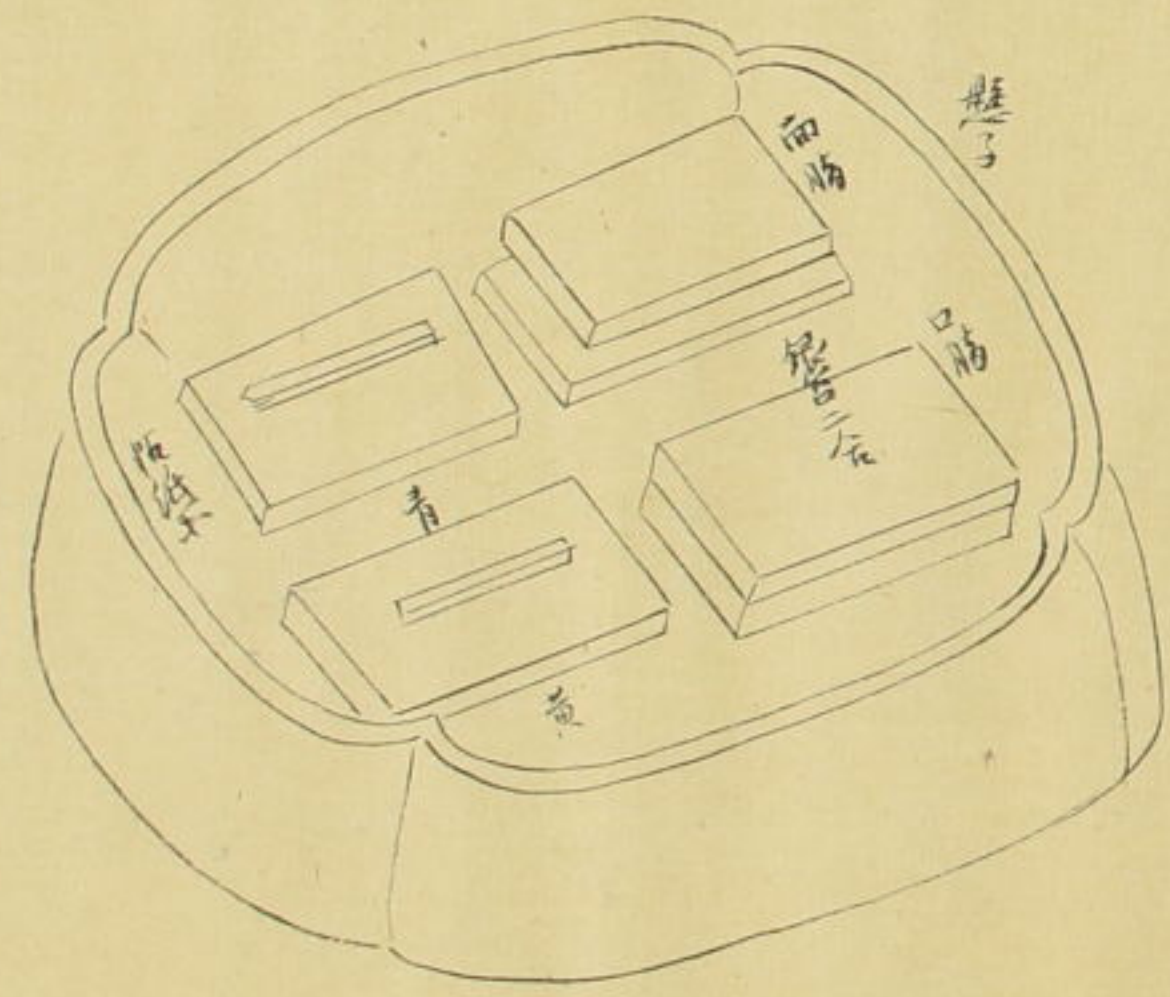
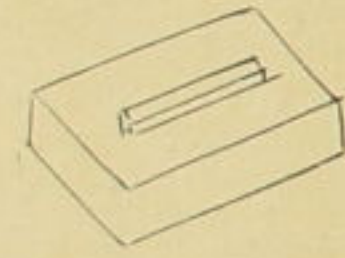

櫃子

御用

御用

御用

御用

後同  
櫃子箱目

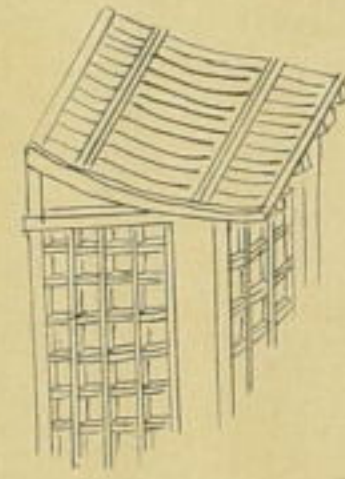

同管  
内享公卿奉

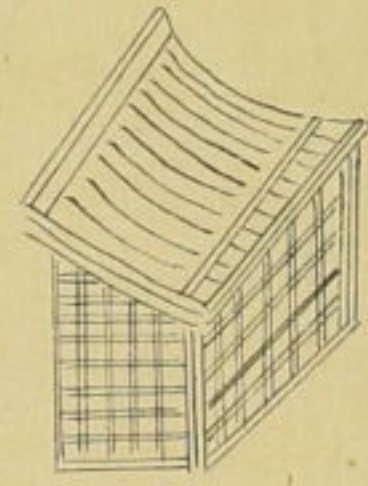

甲管  
外記政始晴儀

銀系金綱



銀垢貫







庭燎金輪圖

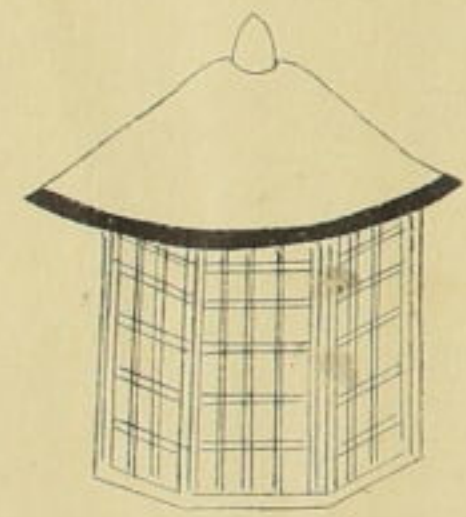

披外前炬舍与木敷前炬舍所造回

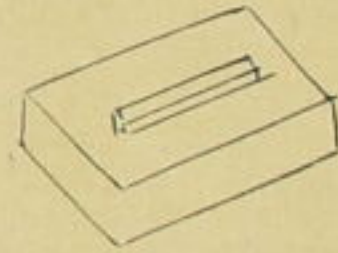
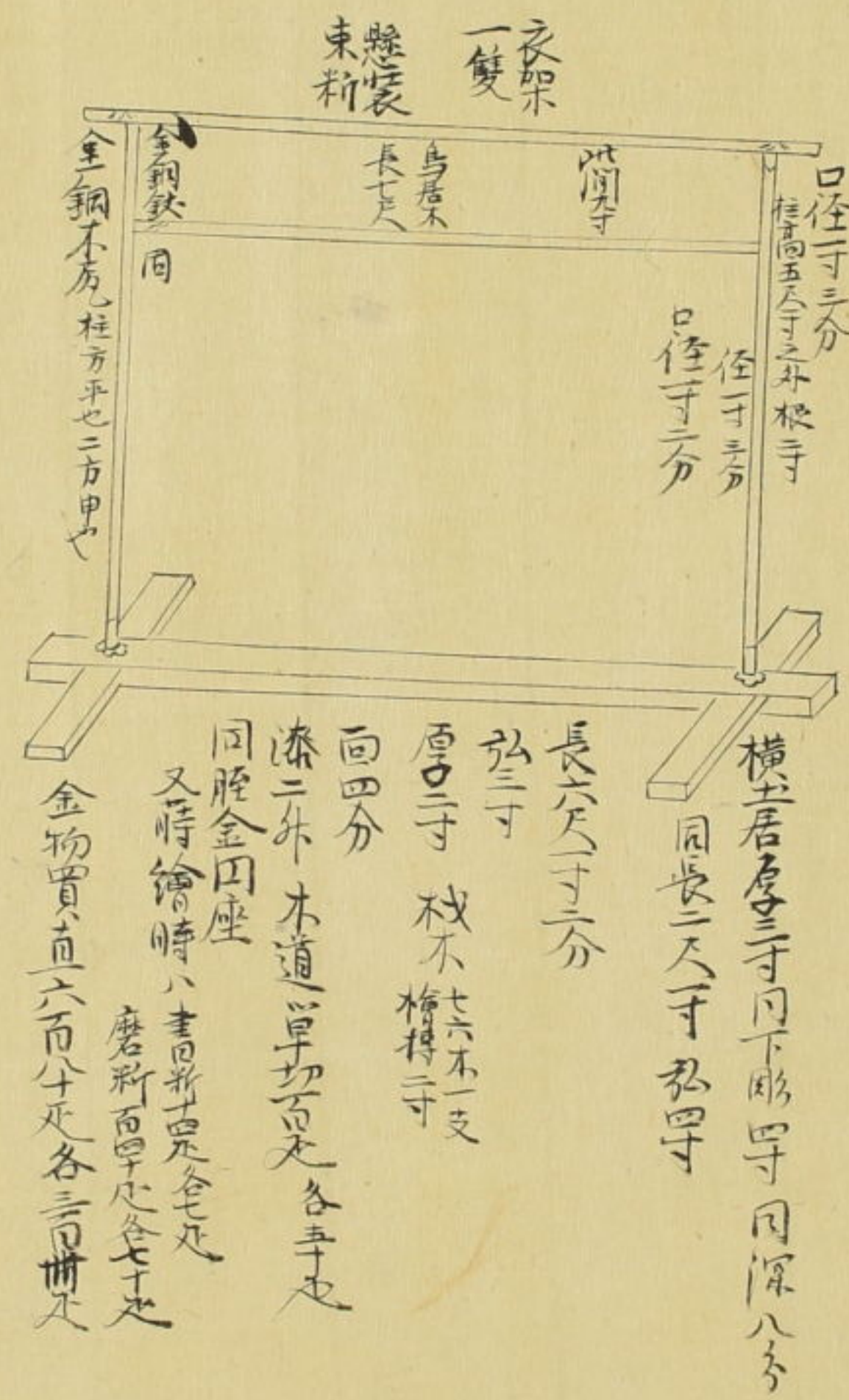

同本目

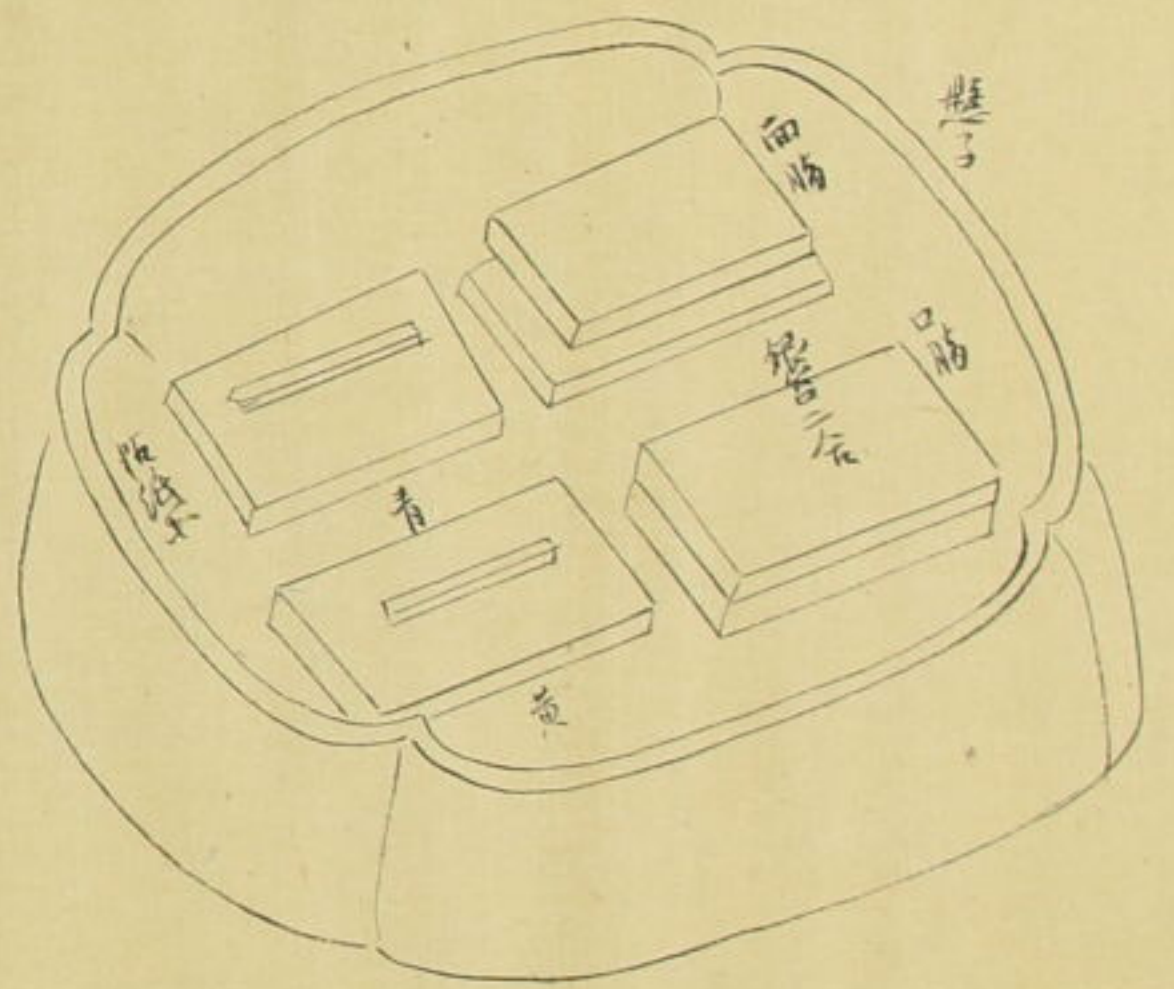



幸中行事朝觀行幸



柳單鞋圖  
幸中行事圖  
豐後院時祭庭座



庭燎金輪圖

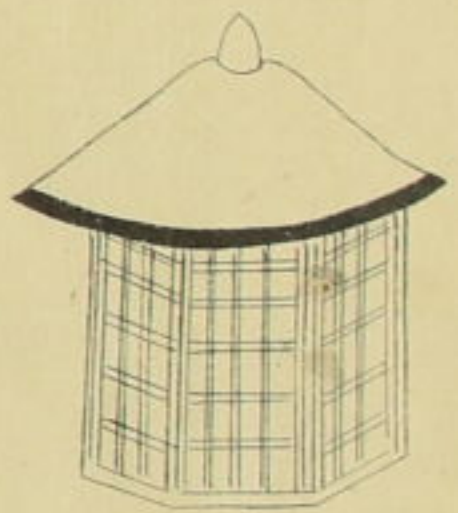

披外前炬舎与木敷前炬舎所造回



柳單鞋圖  
幸中幸画  
賀茂時奈庭屋



幸中行幸朝觀行幸



石於京師後日野資愛卿拜借而騰寫畢

文化十四季九月日

本間百里





73  
8645  
100





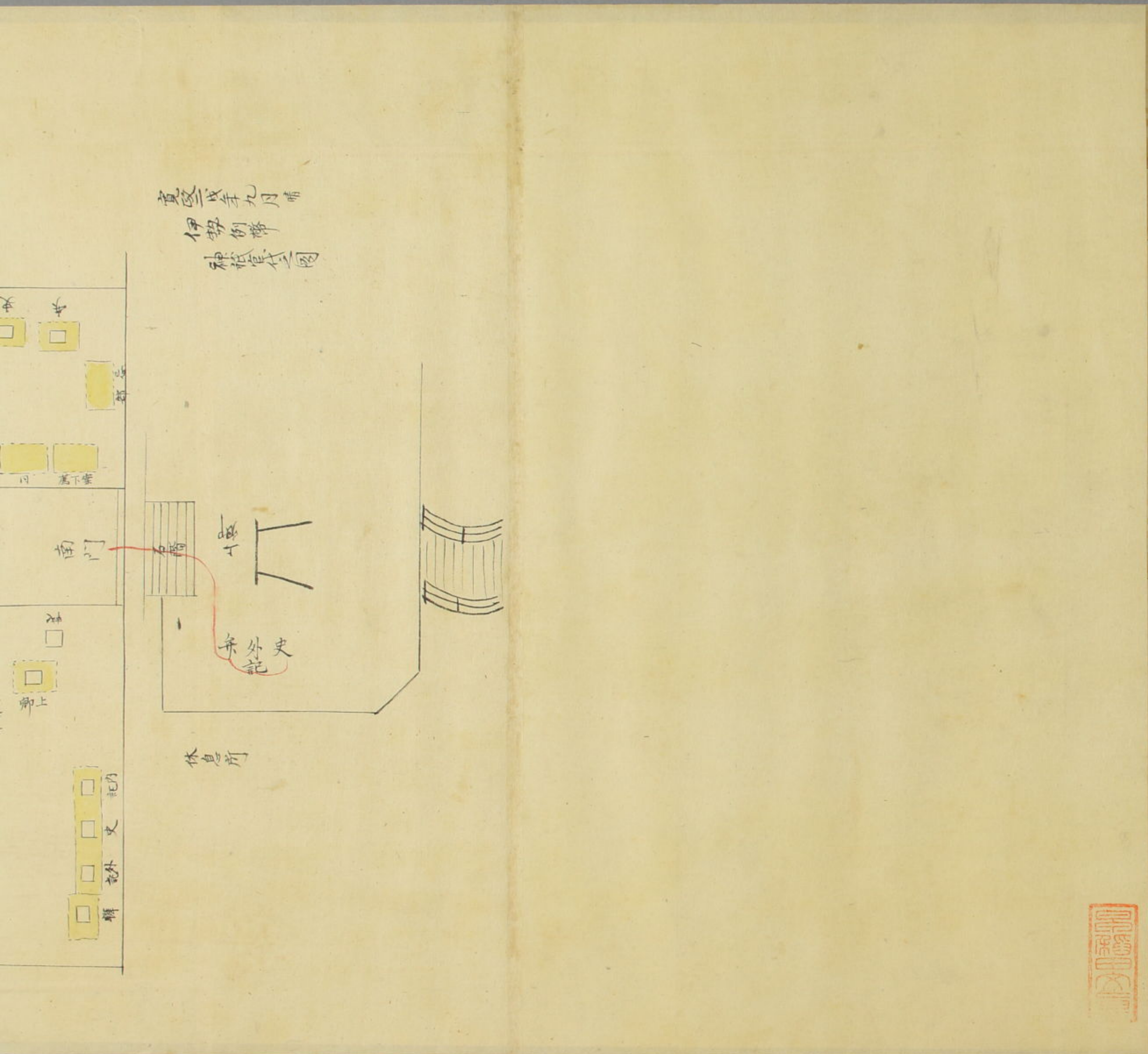

殿内御装束年調度圖 秘

73  
3845  
100



本間文庫

7條子  
3045  
秘







23  
3645  
100