

茶室寸法繪圖

△ 7
3860





△ 7 冊
3860

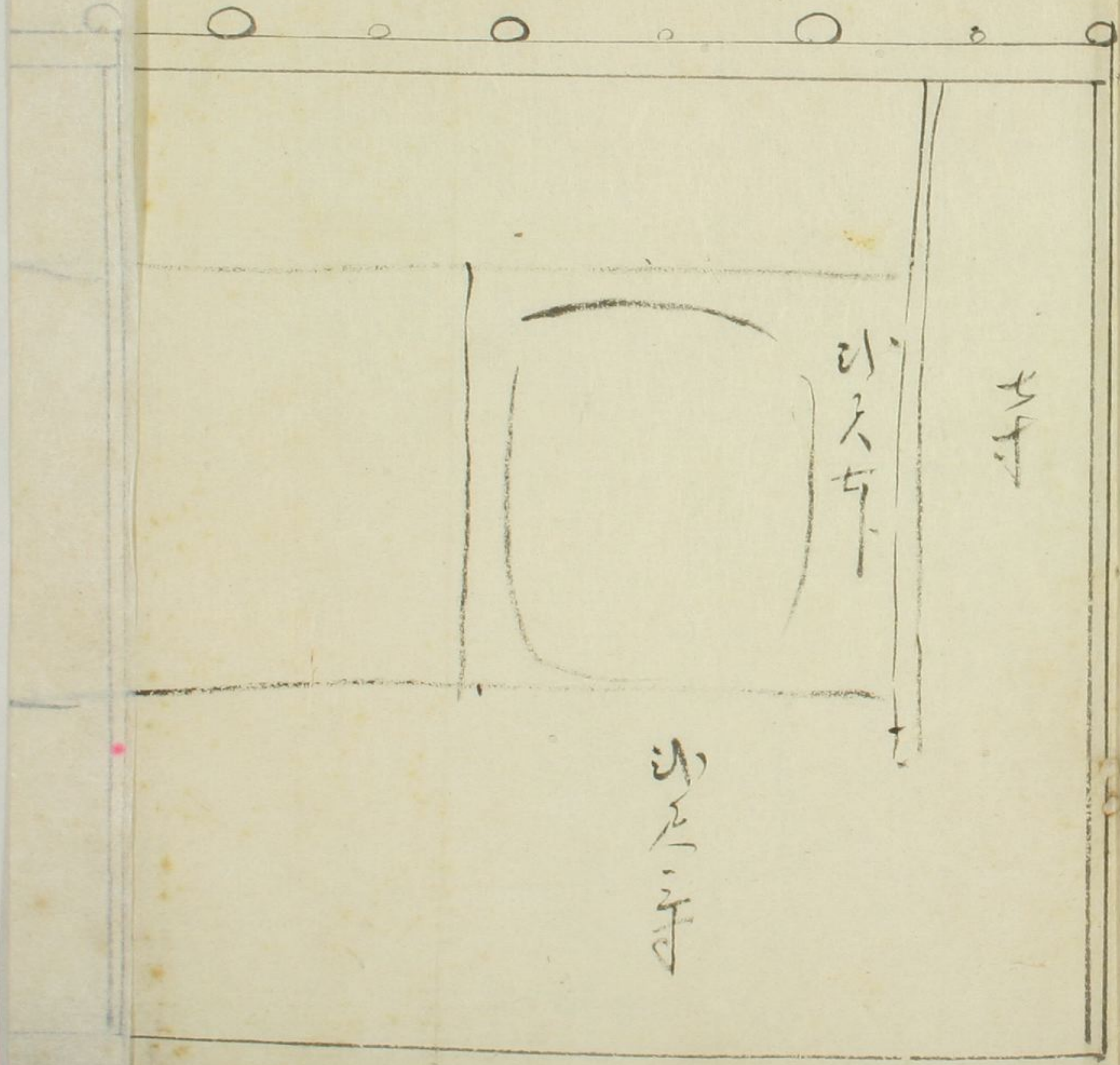



47 特
3860

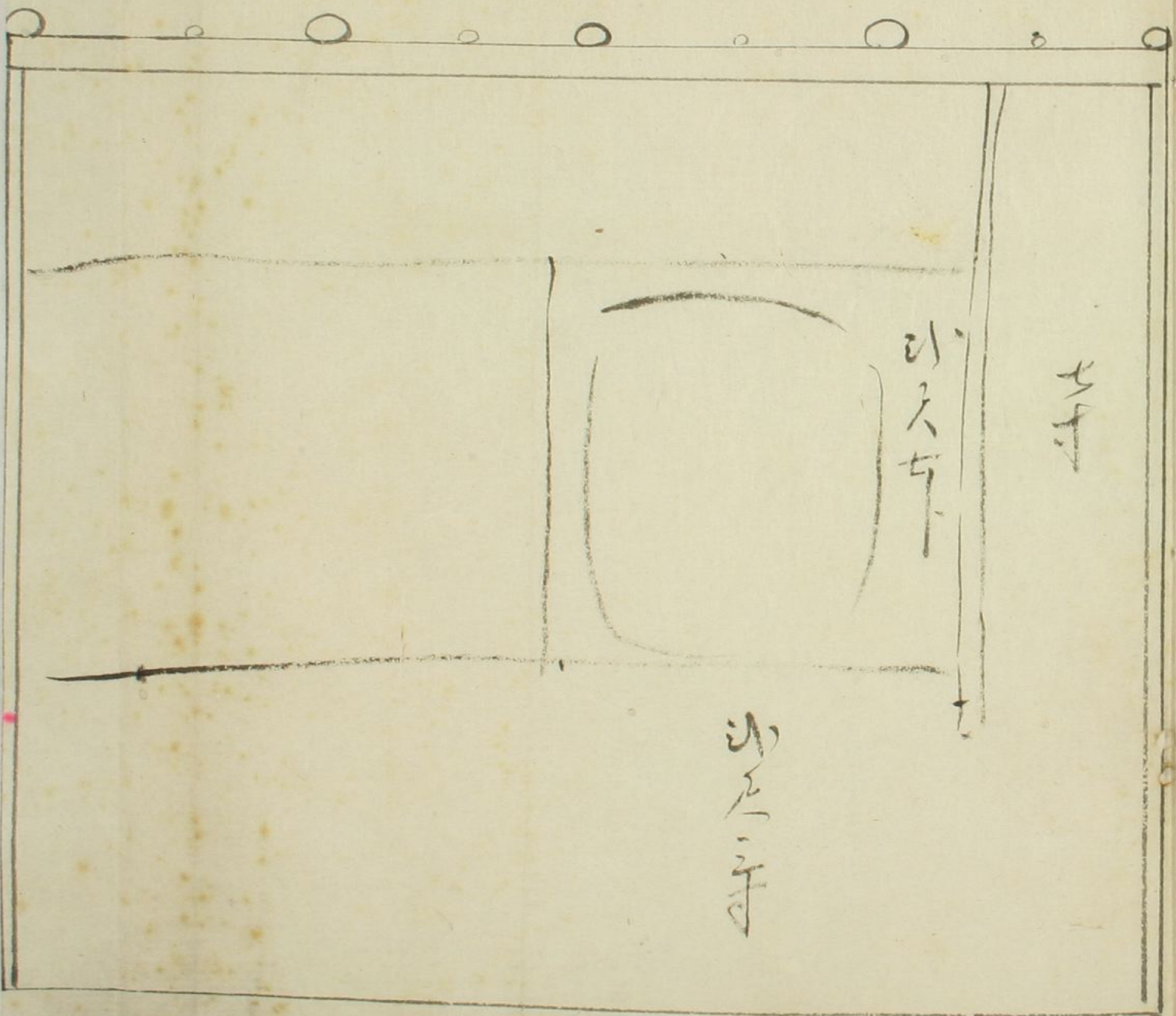

山天寺

山天寺

七寸

仲太夫
三寸

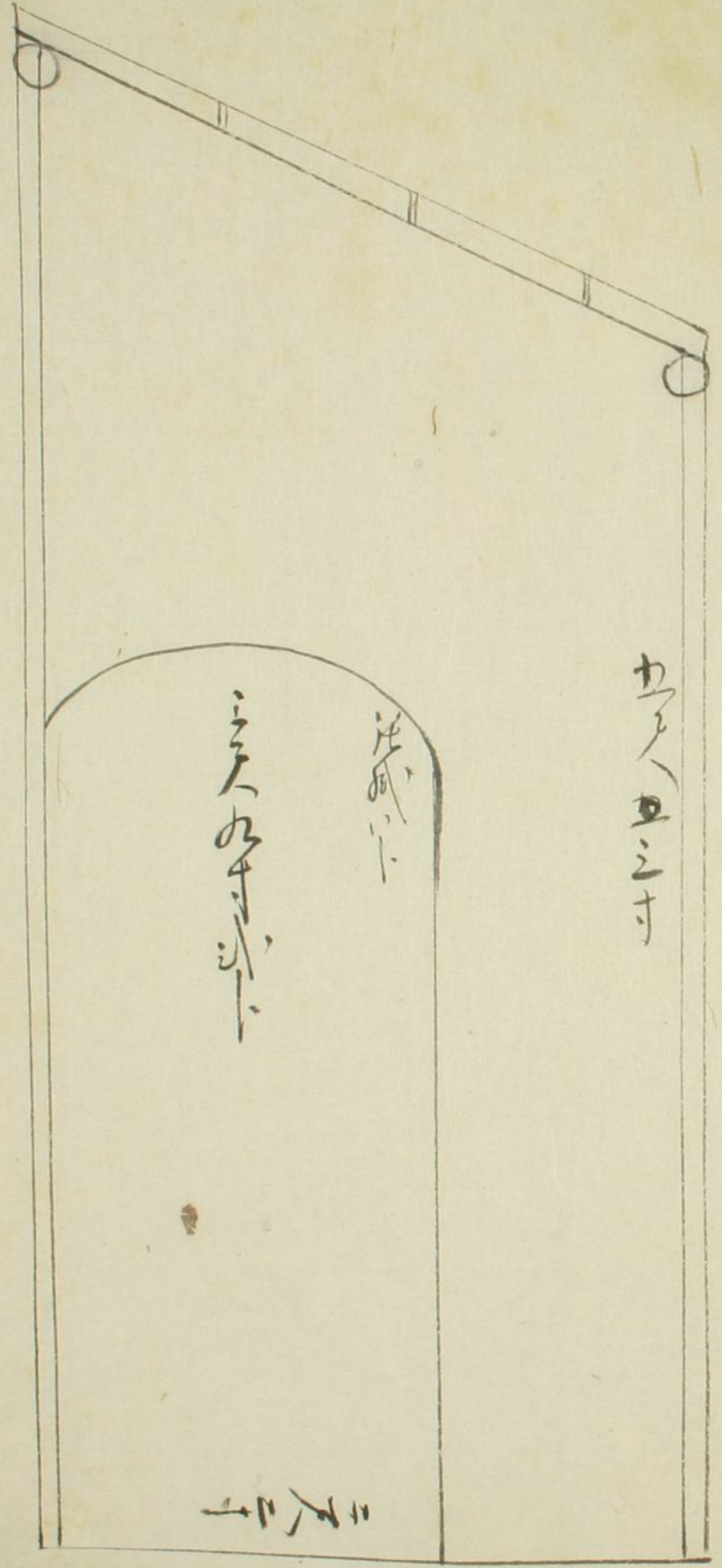

カ
五寸

注
下

三
尺
寸
下

三
尺
寸

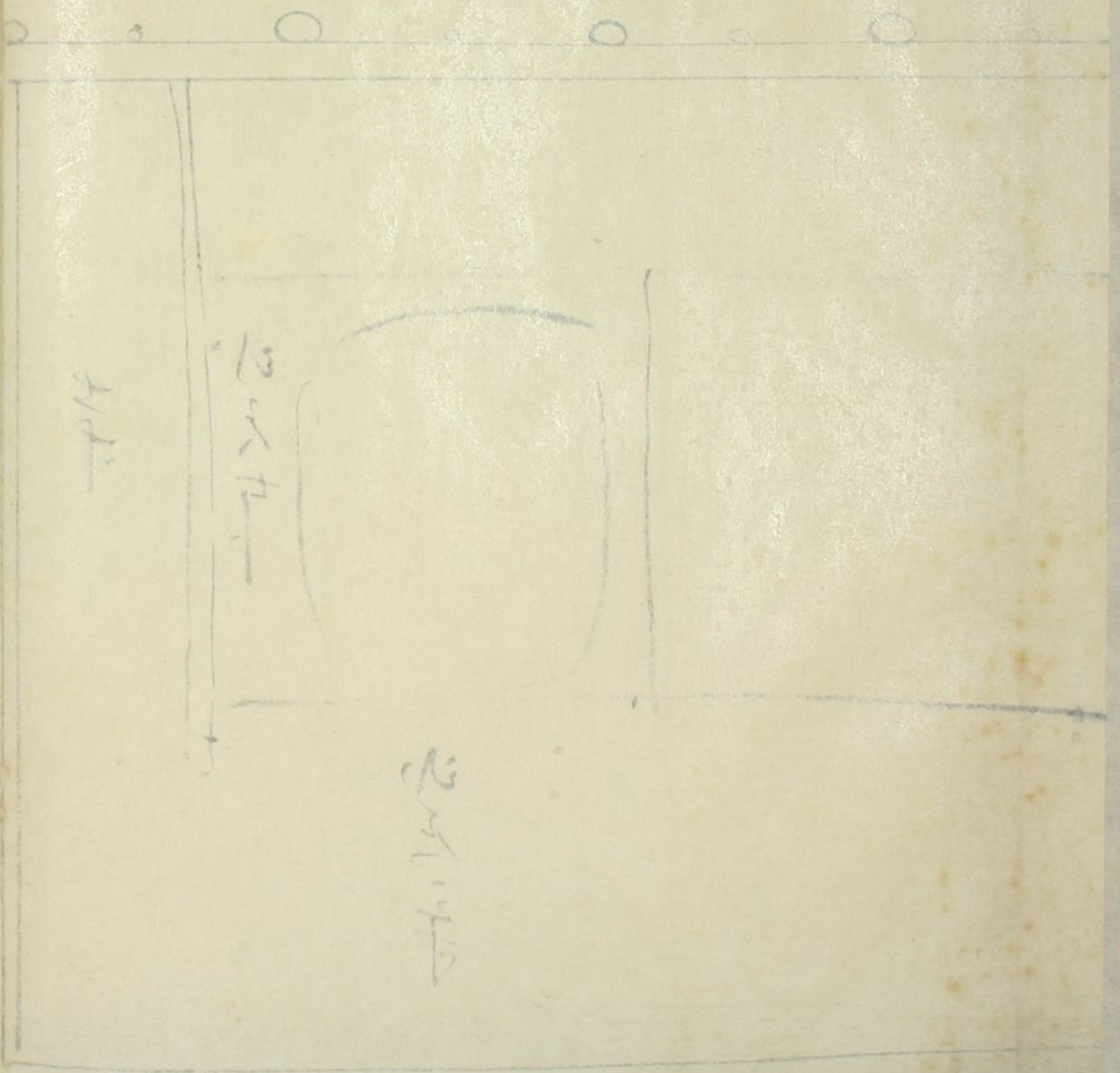

カ
下

三
尺
寸
下

三
尺
寸
下

Handwritten notes at the top of the right page, possibly describing the drawing or providing a title.

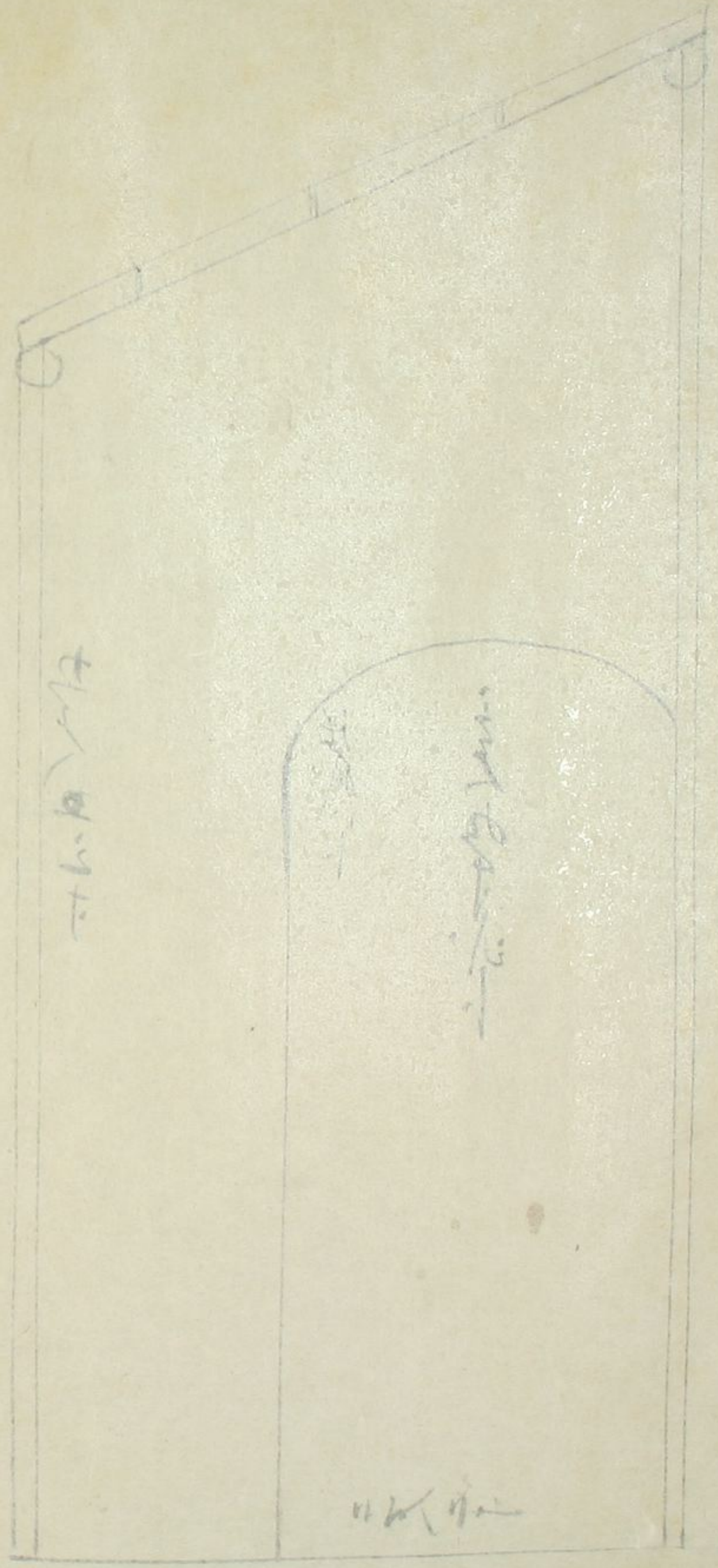

Handwritten text on the left side of the right page, possibly a label for the drawing.

Handwritten text at the bottom of the right page, possibly a signature or date.

Handwritten text '一人' (one person) written vertically on the right side of the left page's diagram.

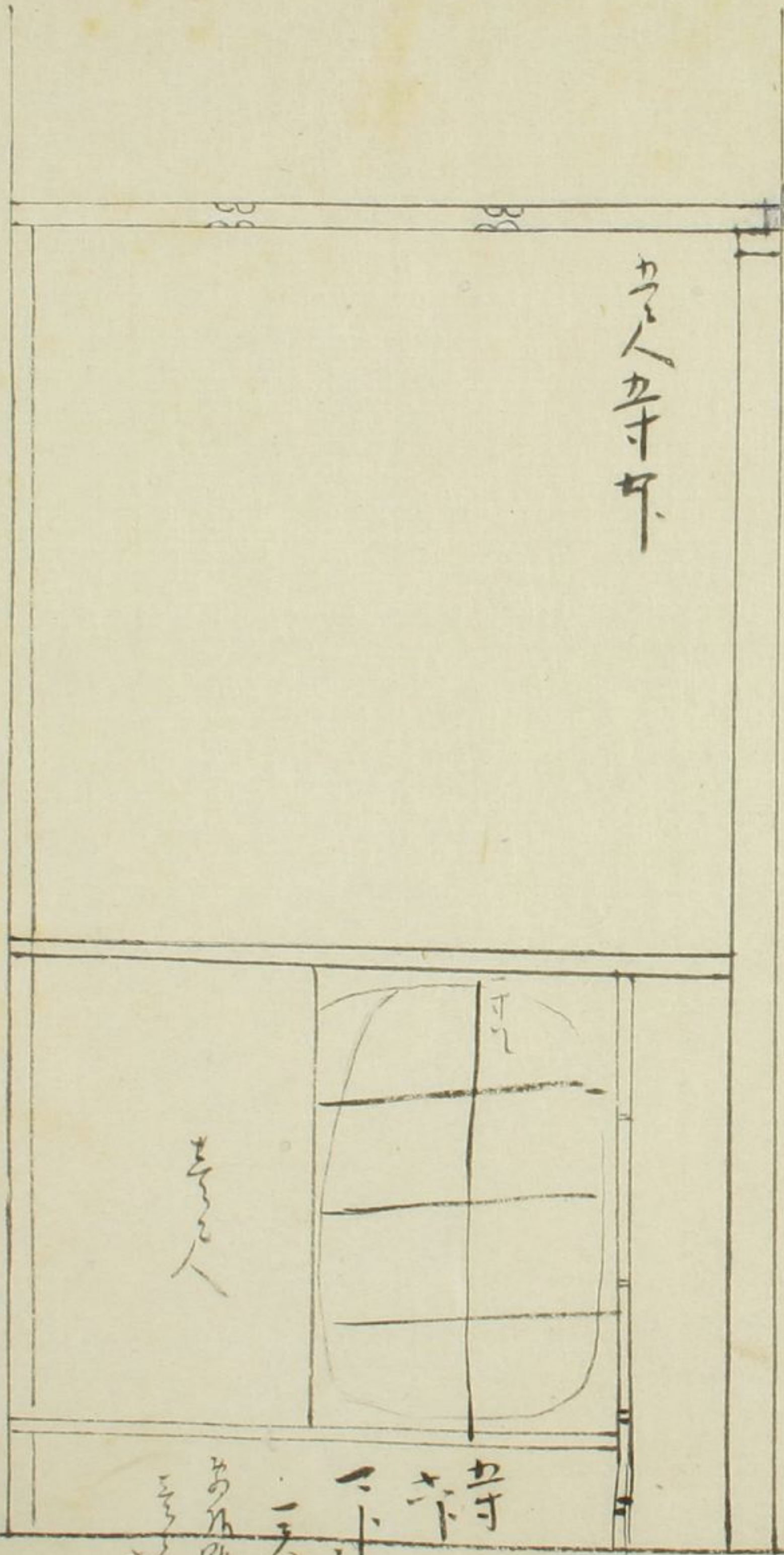

Handwritten text '一人' (one person) written vertically inside the diagram on the left page.

Handwritten text '一人' (one person) written horizontally at the bottom of the diagram on the left page.

Vertical handwritten text on the left side of the left page, possibly providing dimensions or a description of the diagram.

Handwritten text at the bottom of the left page, possibly a signature or additional notes.

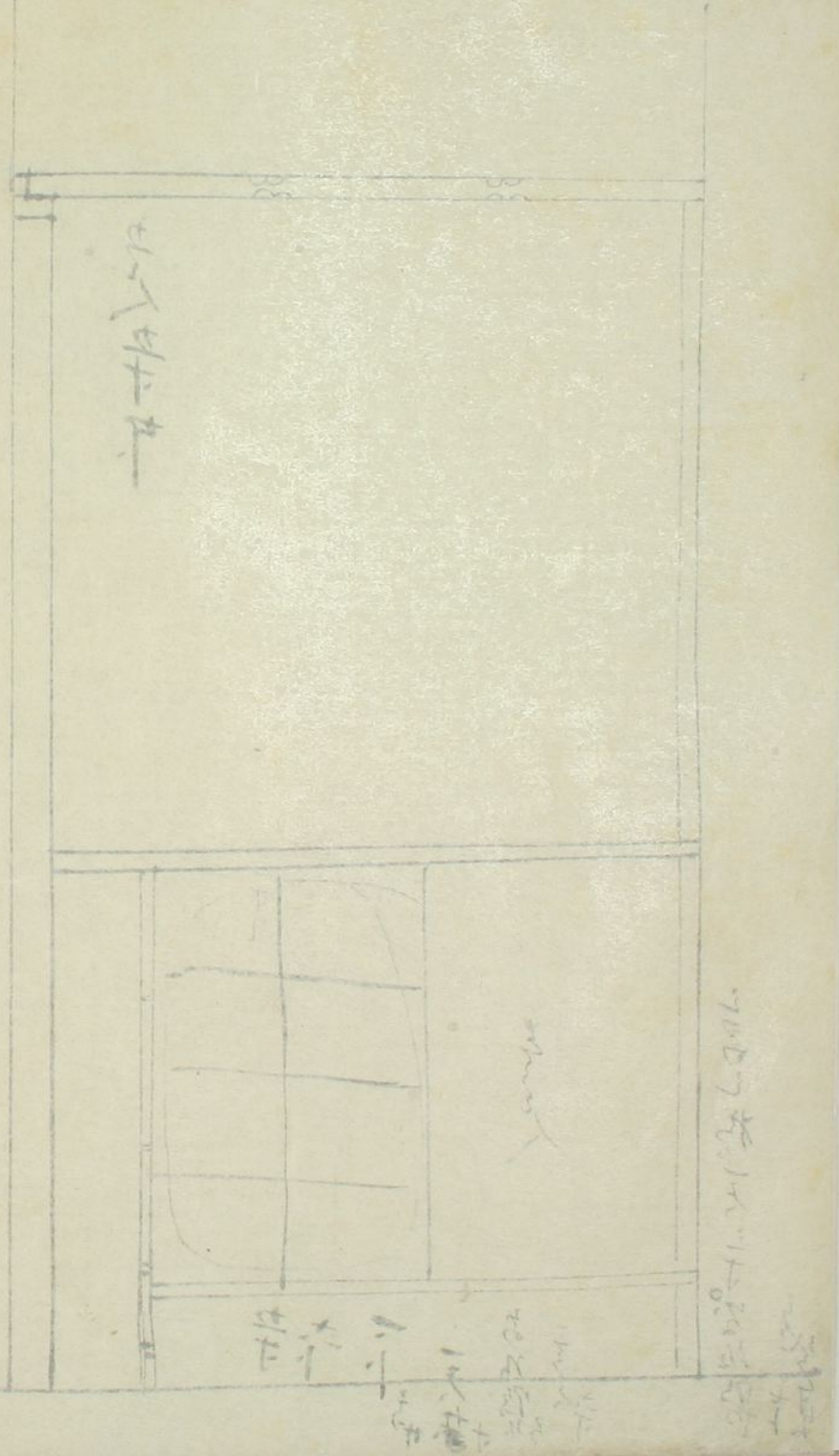
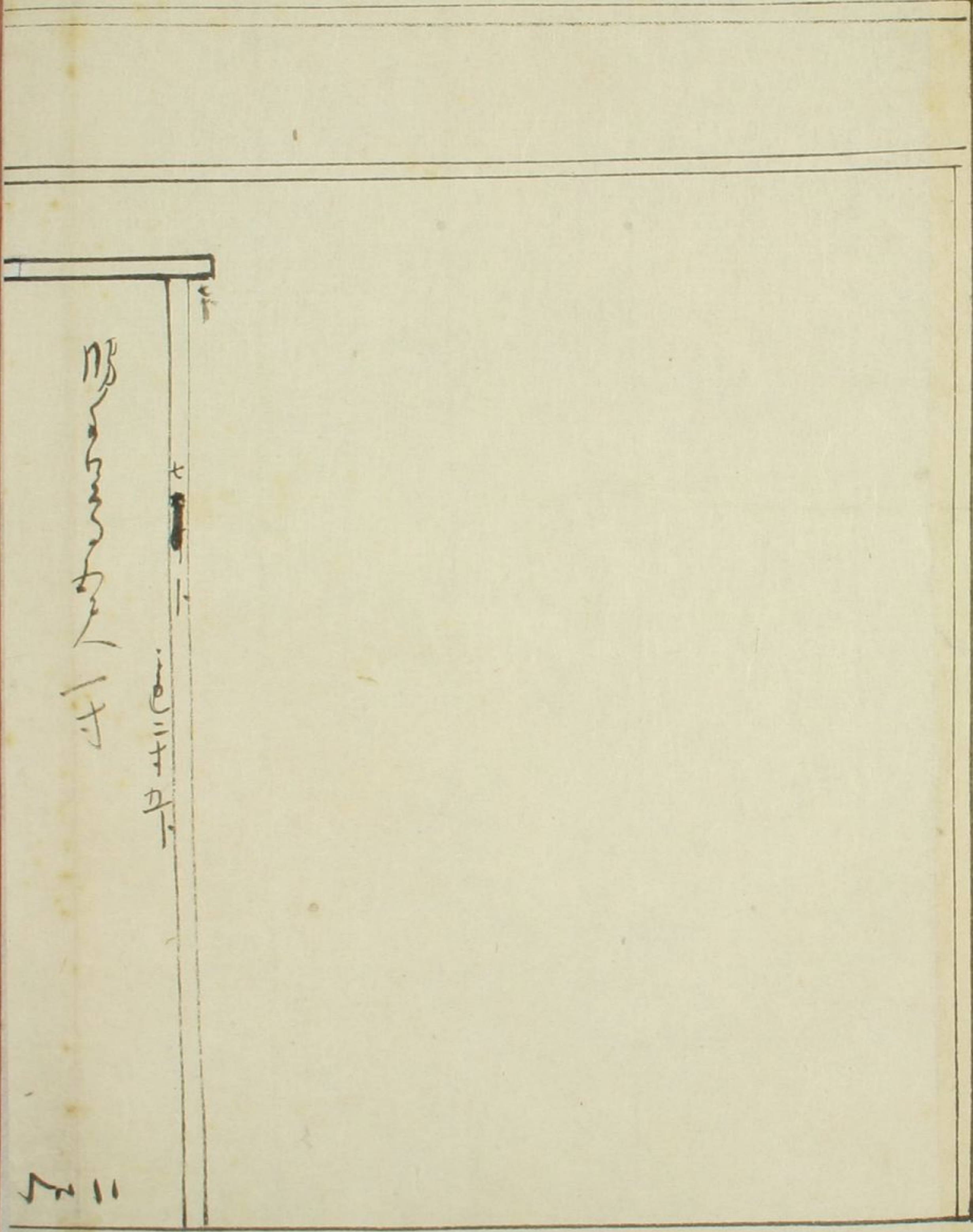

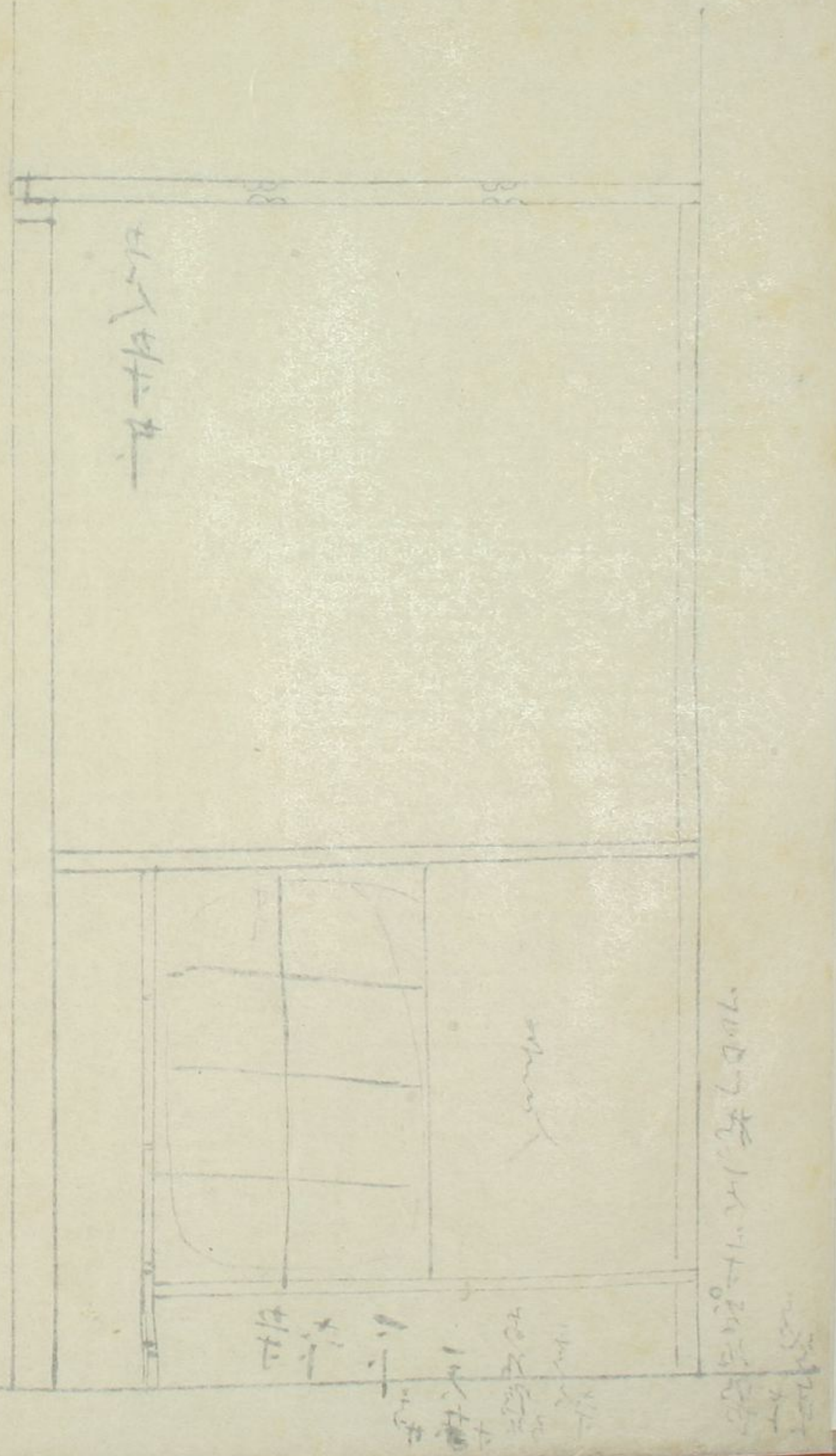
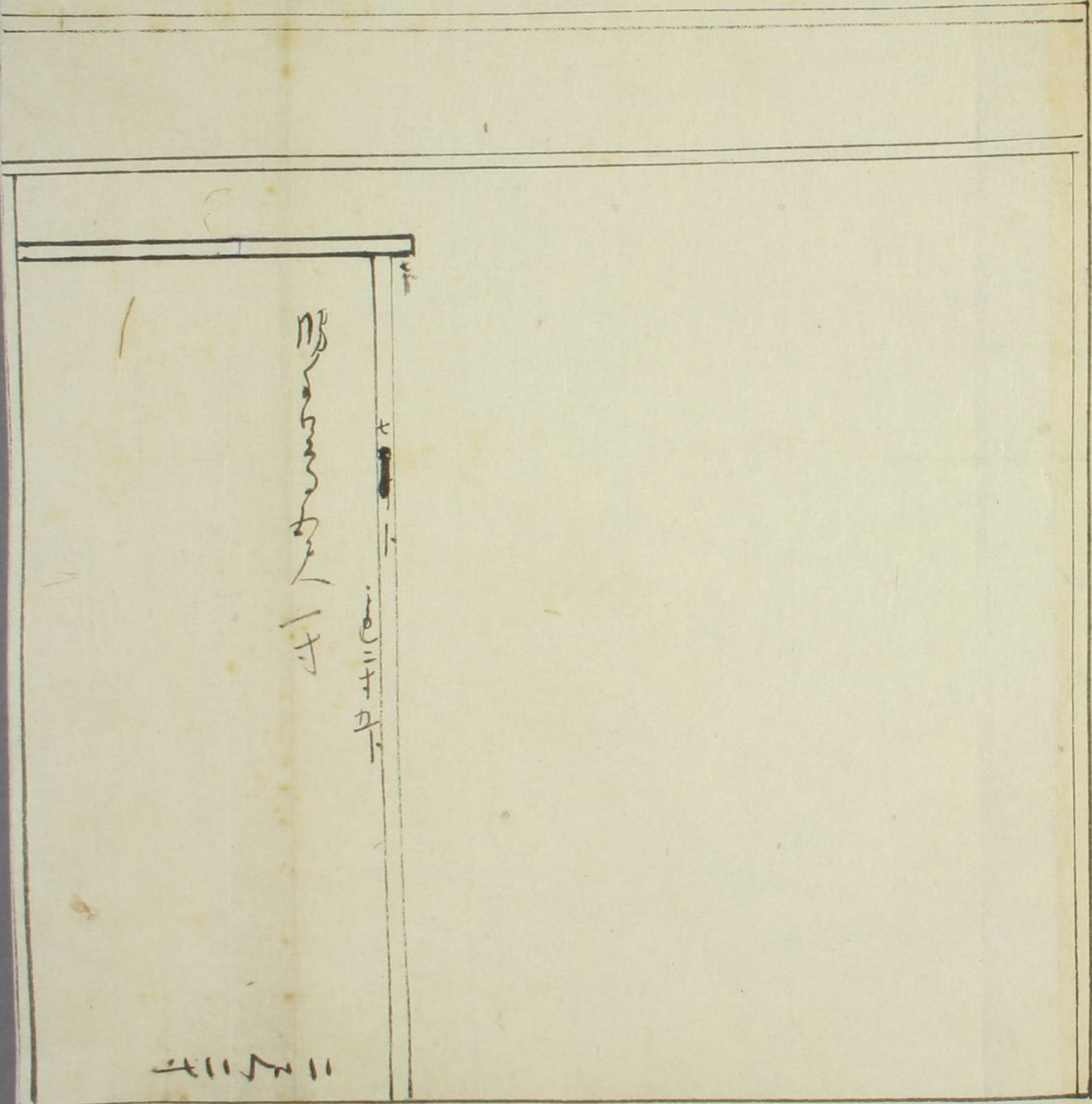

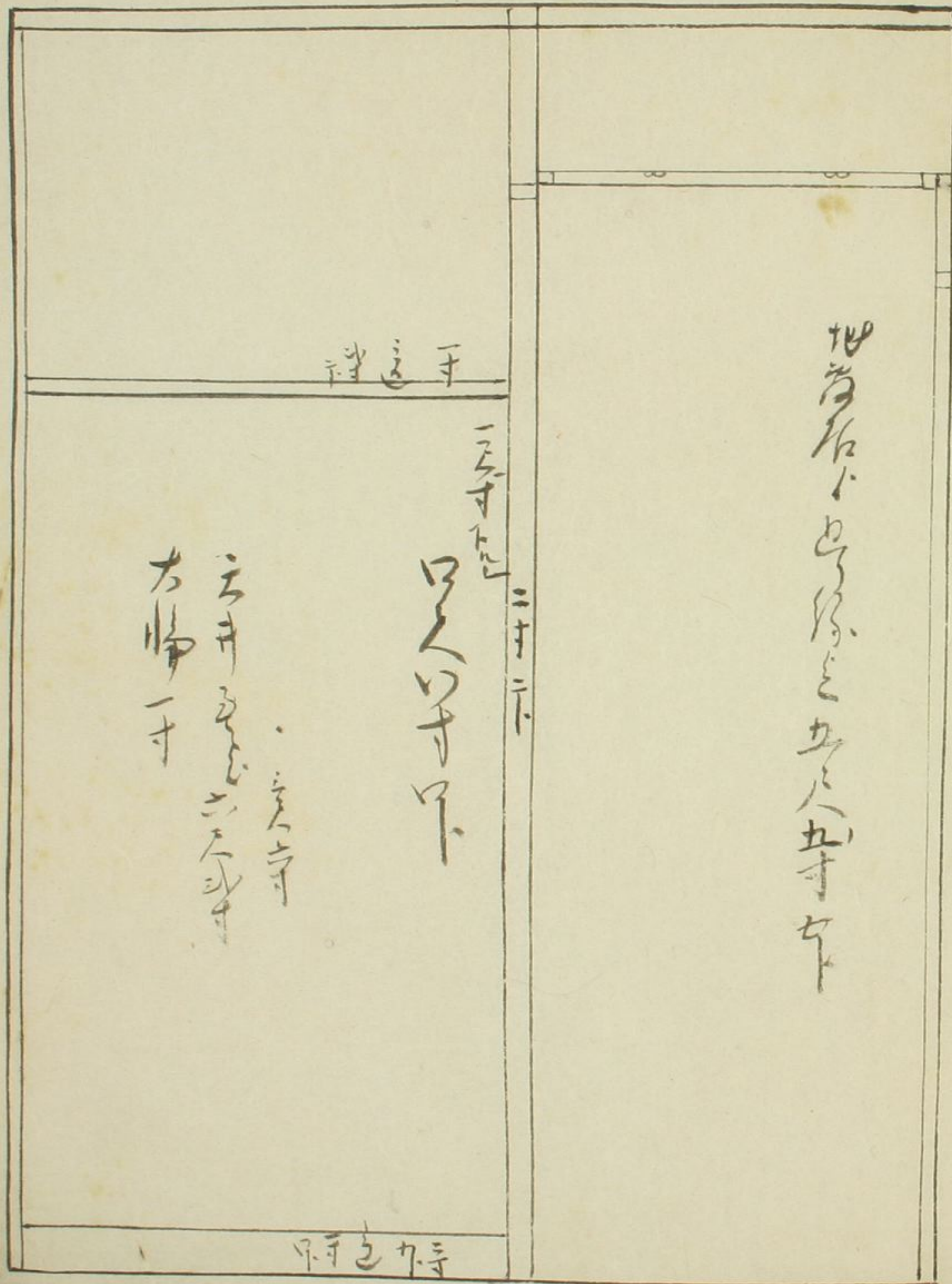

世帯下
只人守下
大佛下

三寸上
二寸下
大佛下

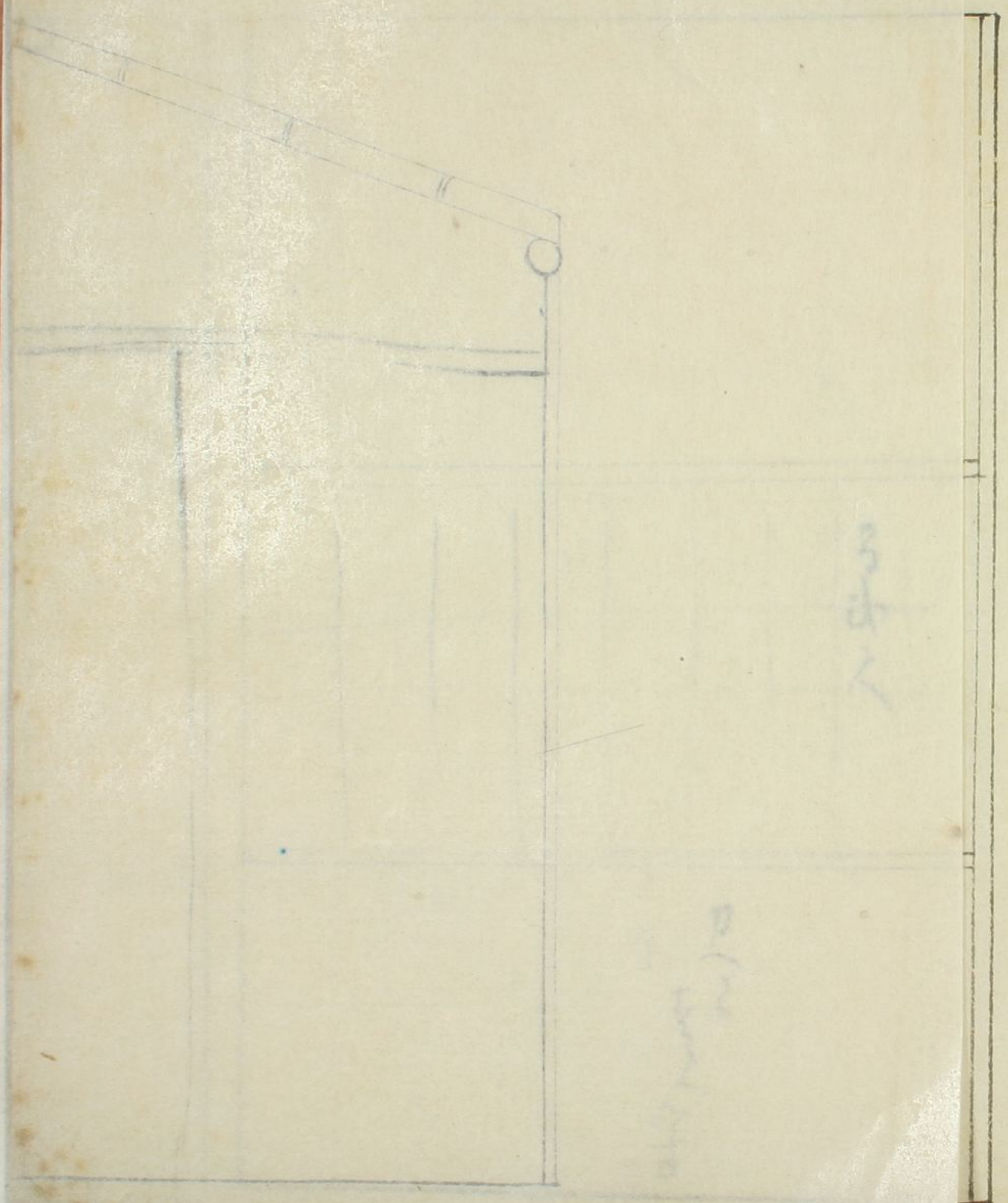

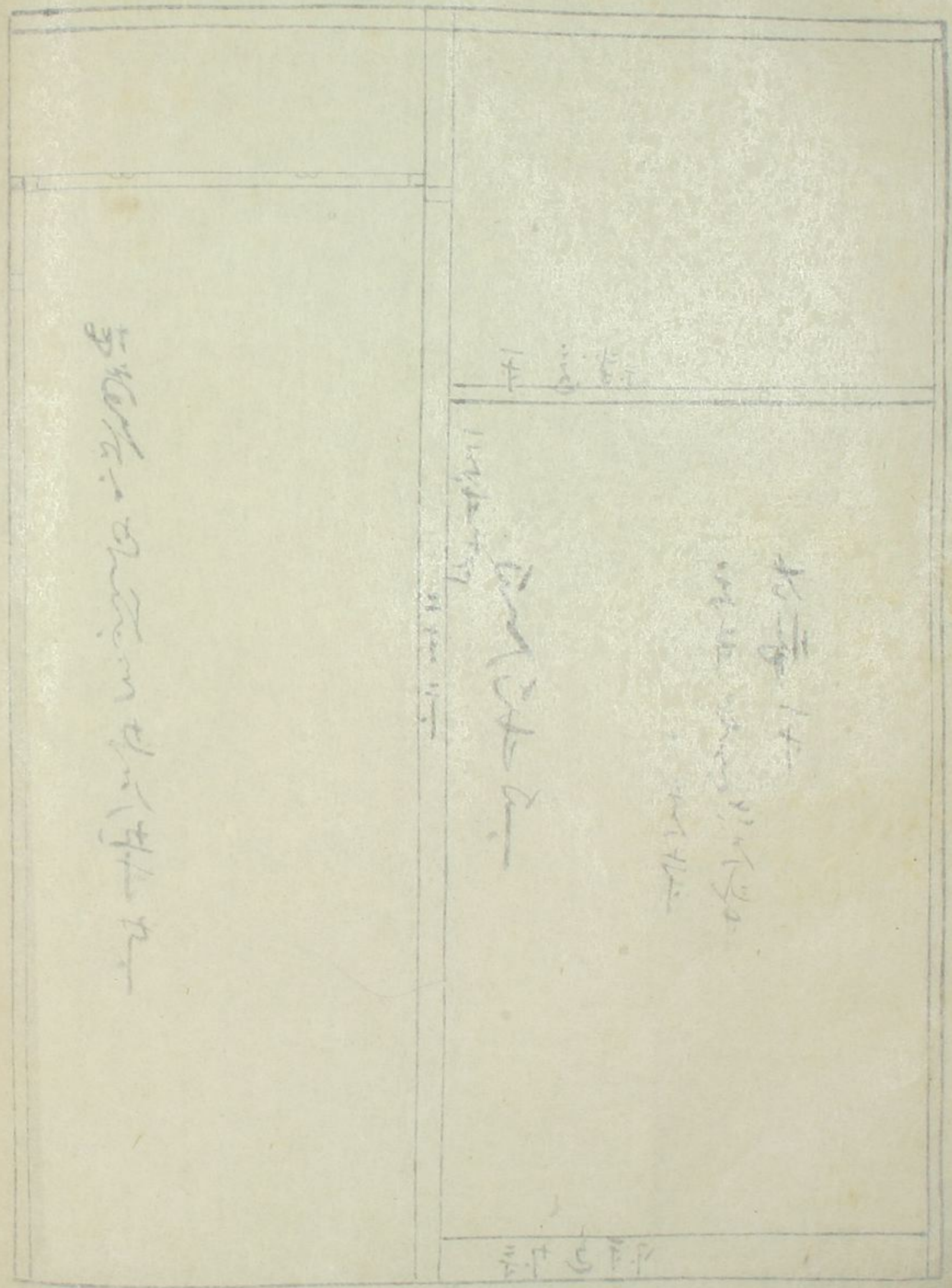
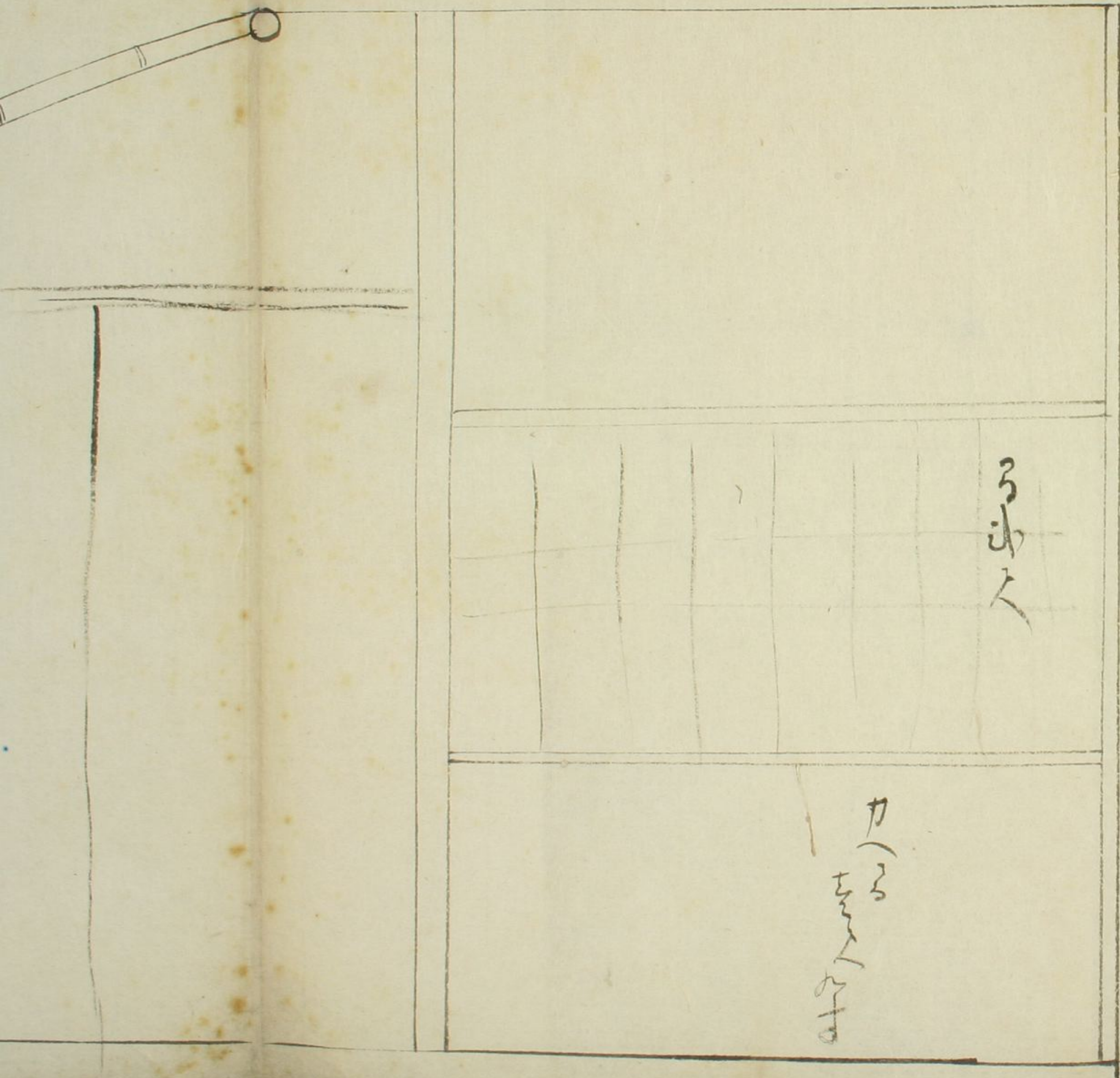

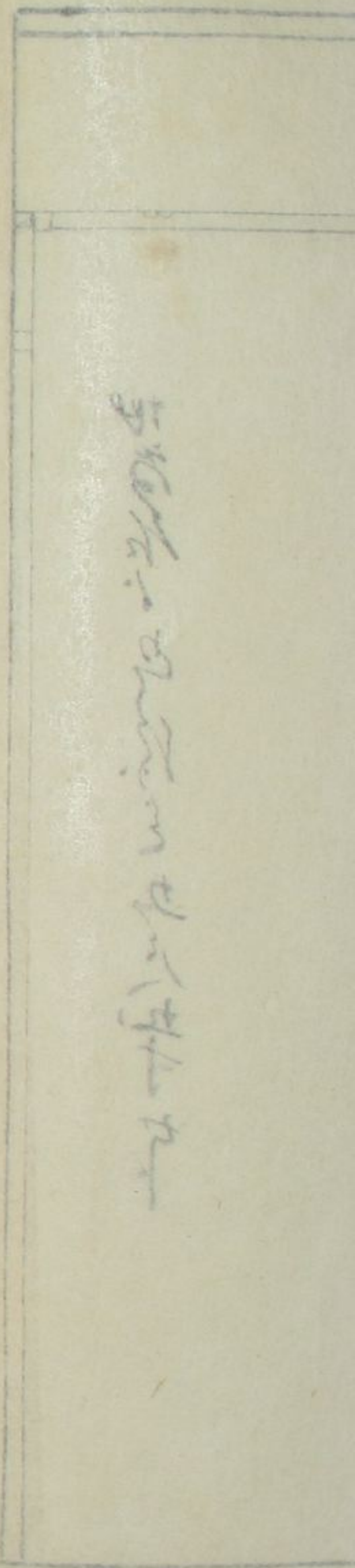
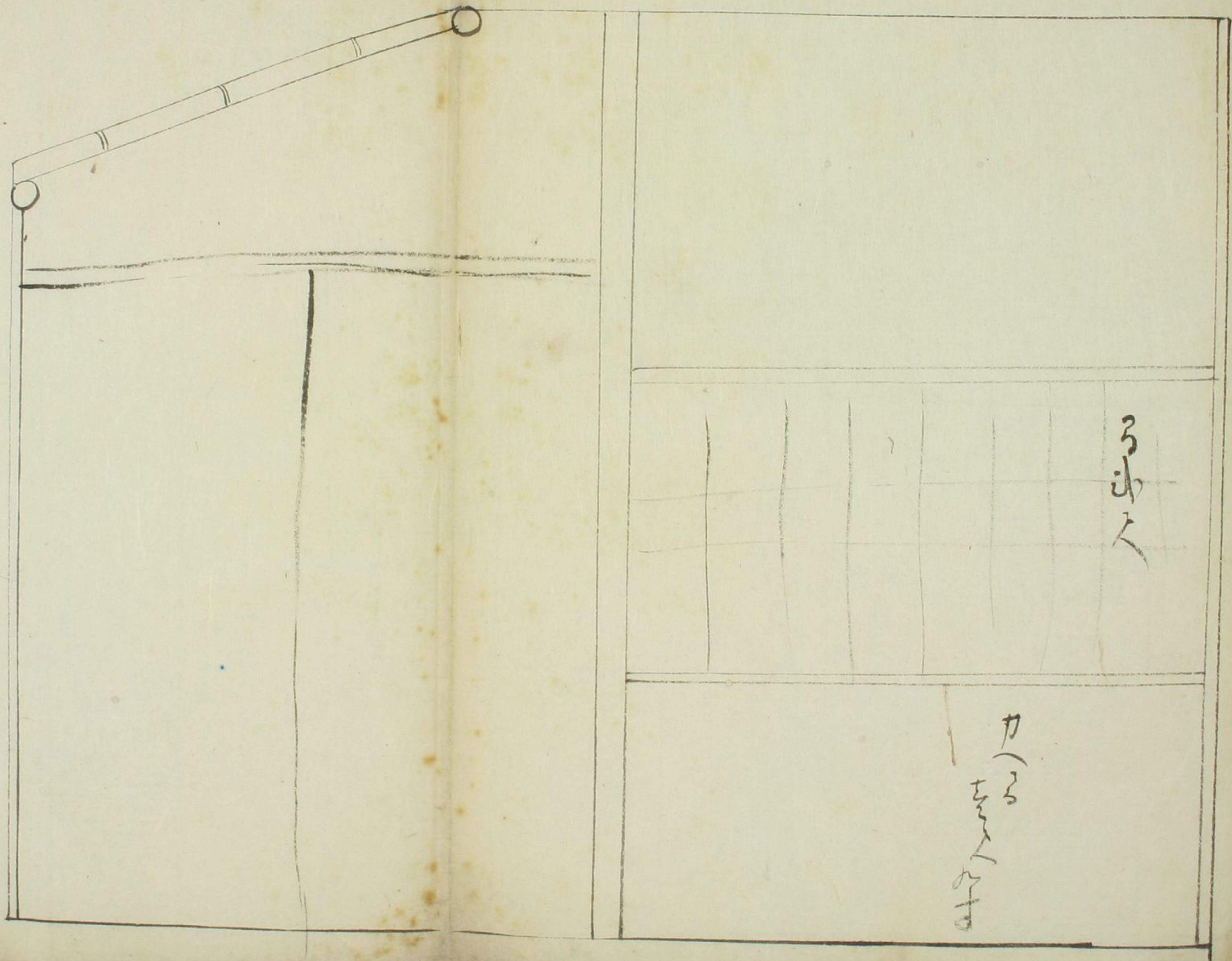

Handwritten text in a vertical column, possibly a title or label, written in a cursive or shorthand style.

the first that $\frac{1}{2}$ to
to

1000

1000
1000

to have the

222

15/10
18/10

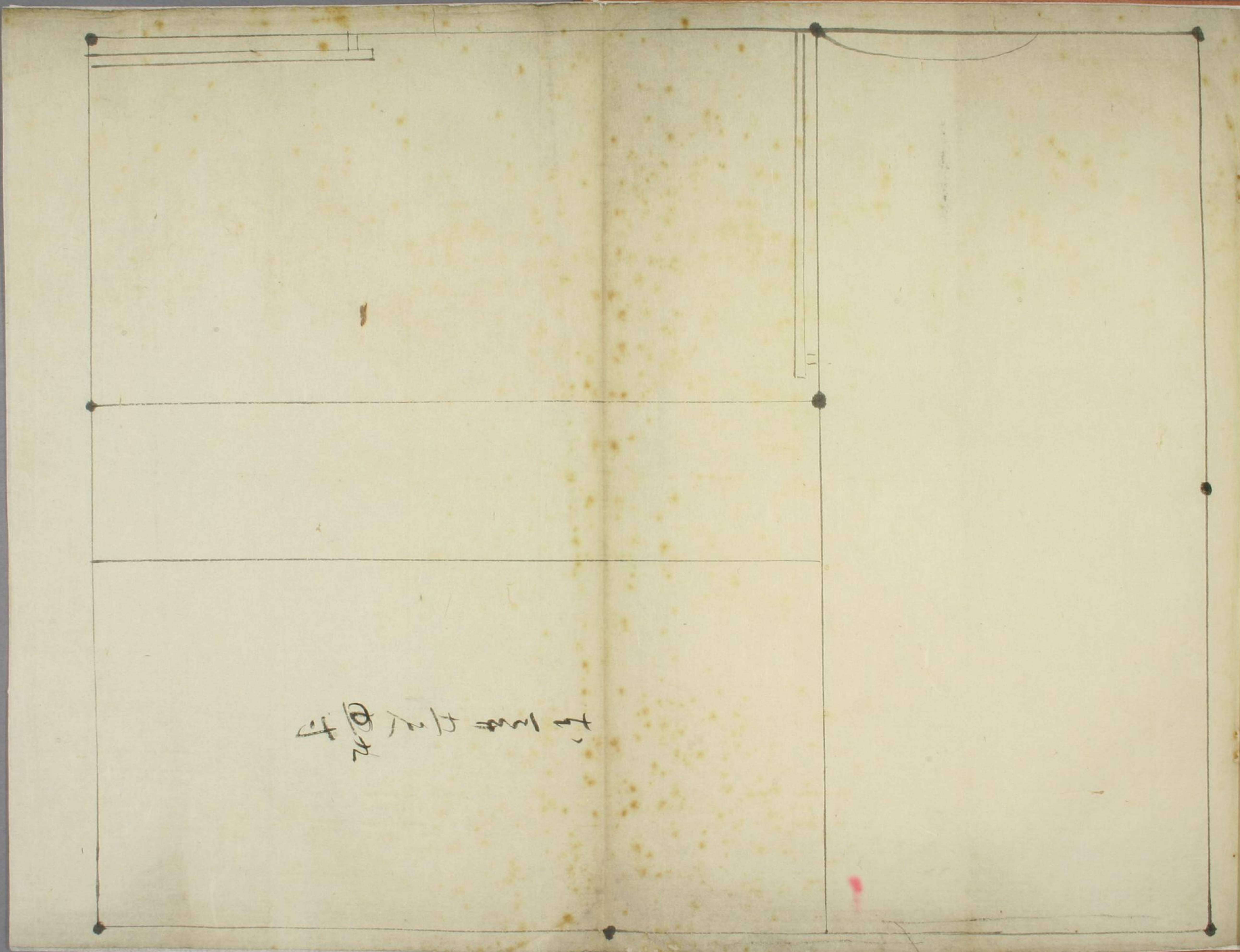

Handwritten text, possibly a signature or date, oriented vertically in the lower-left quadrant of the page.

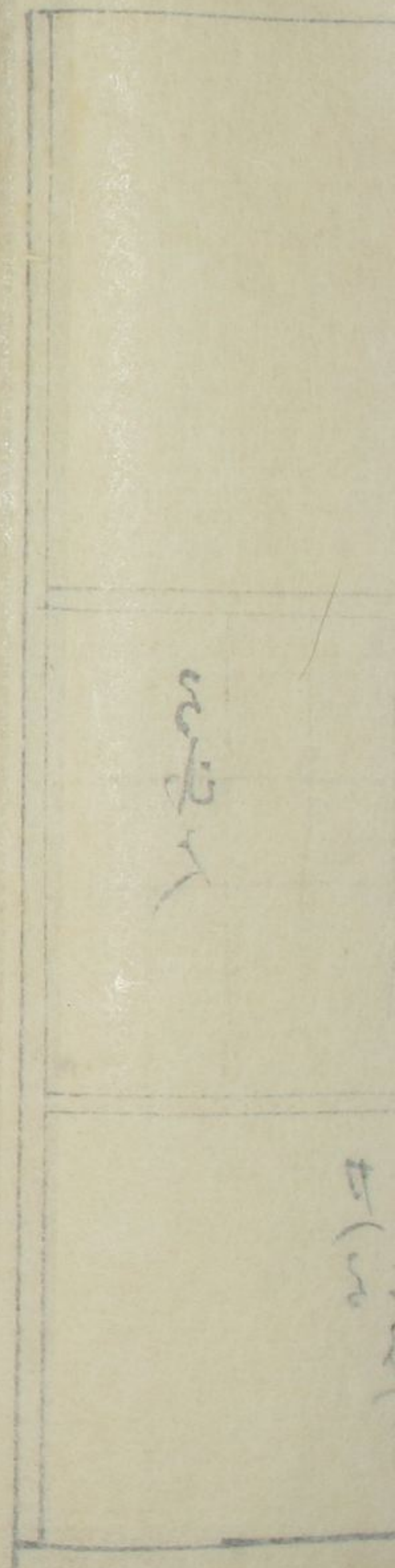

Handwritten text, possibly a signature or date, oriented vertically in the middle section of the right page.

Handwritten text, possibly a signature or date, oriented vertically in the bottom section of the right page.



