

# 海上派遣軍作戰一覽圖

(日五月三至日九十二月二)

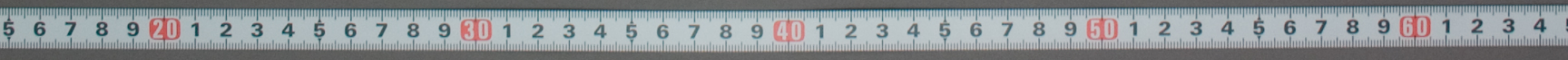

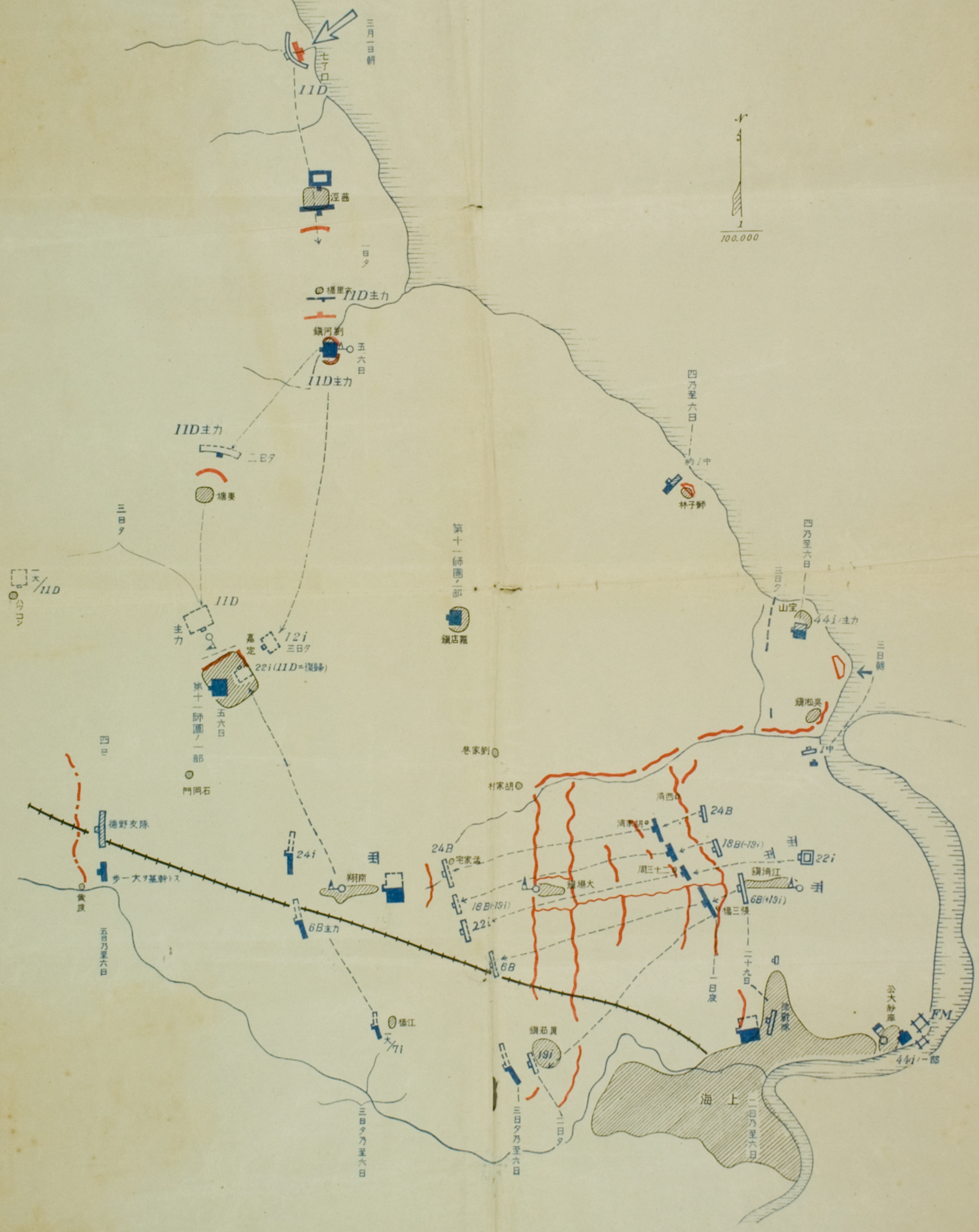

第一圖

上海の聖母堂の内部の構造  
 上海の聖母堂の内部の構造  
 上海の聖母堂の内部の構造

1539  
 1539

Handwritten notes in Japanese, including the number '1539' and several lines of text describing technical details or construction methods.

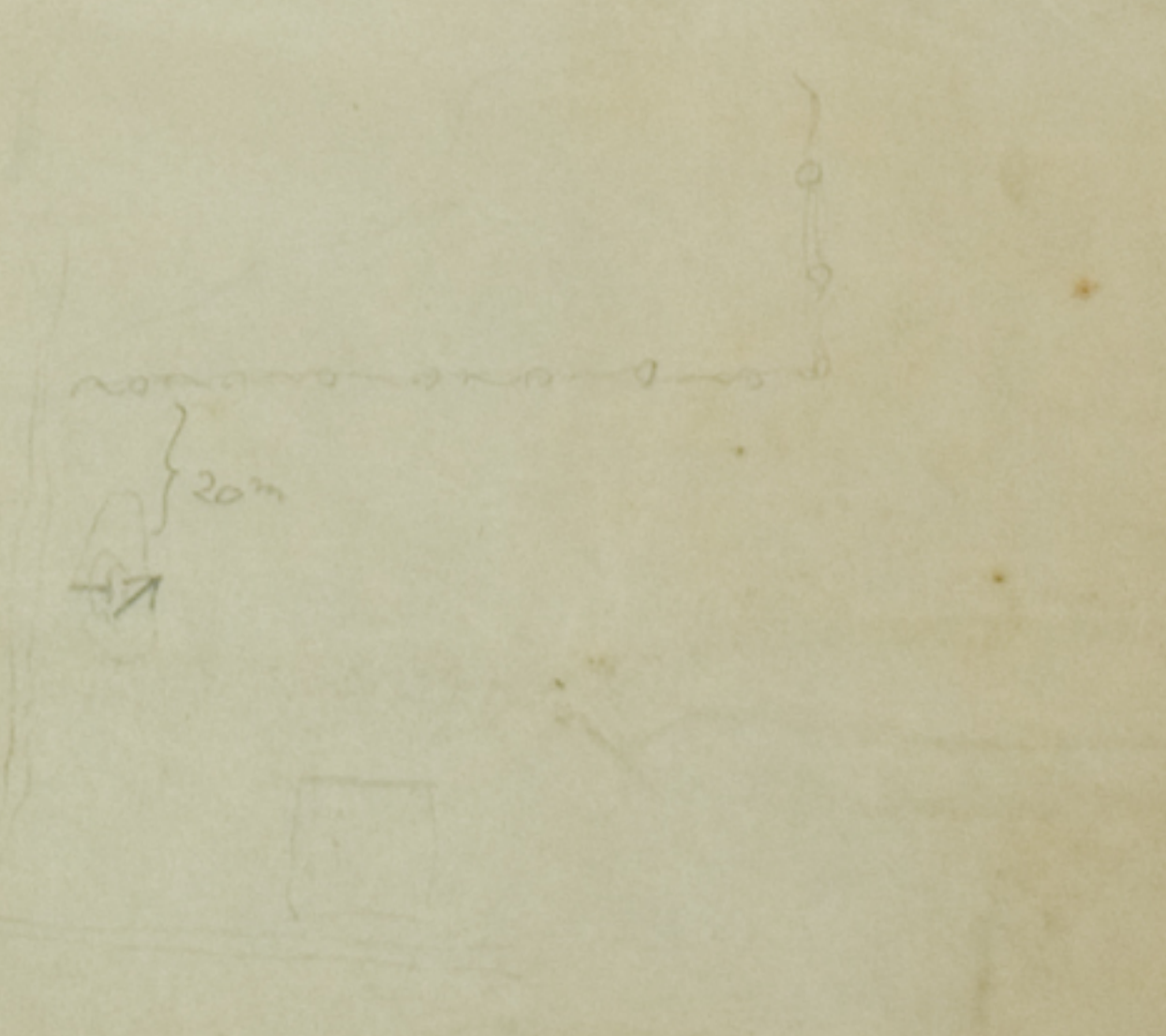

昭和十七年四月十四日寄  
 寺田利邦氏贈





Handwritten notes in Japanese, including names like 南郷 and 空州の地, and numerical data like 36, 41, 33, 27.

Main body of handwritten notes in Japanese, containing a list of items and their values such as G D 9,000 and 最 1,500.

Vertical handwritten notes on the right page, possibly a list or summary of the items mentioned on the left.

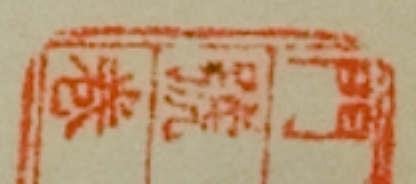

上海是暗是由全国的搞乱来  
上海的多是些由本国的自乱来  
野区搞乱上海的一九路  
打倒帝国主义的人民

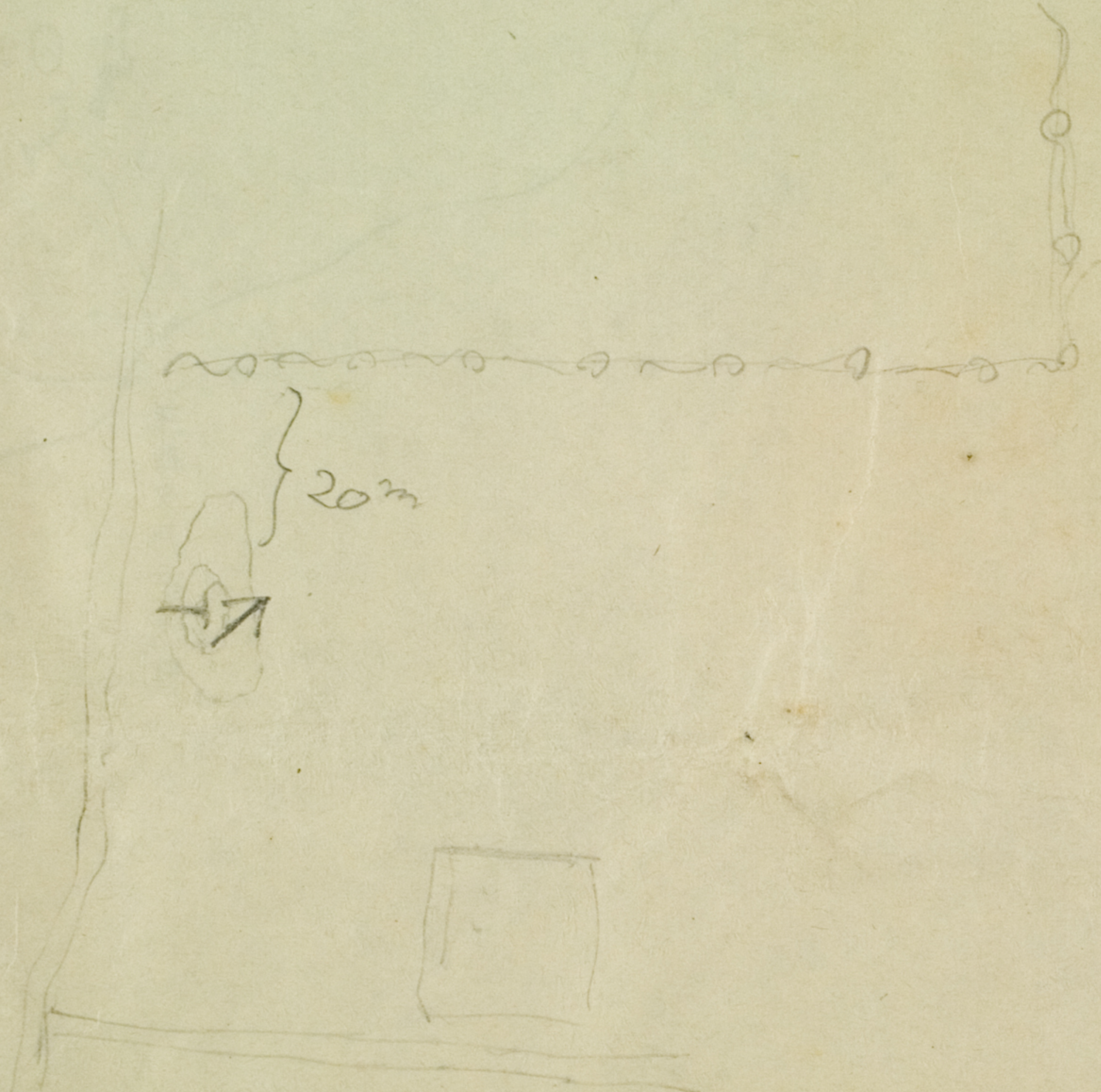

昭和三十七年四月十四日  
寺田利邦氏  
贈 寄

37 13567



