

一
牝
源
氏



光澤氏結核の村と云ふ事十箇年海に
一系流の石上東門池ありて其の東に
石上東門池ありて其の東に
北にありて其の東に
石上東門池ありて其の東に
北にありて其の東に
石上東門池ありて其の東に
北にありて其の東に
石上東門池ありて其の東に
北にありて其の東に



歌と物と初とつてなまに始とる式歌のつて
 い物とる一部のつてむとるのつて
 りとるつてつてつてつてつてつてつて
 つてつてつてつてつてつてつてつて
 王天台一心之歡血源許可

堤中納言兼輔 惟正 為時 女

母 為任 女

いてつてつてつてつてつてつてつて
 つてつてつてつてつてつてつてつて
 つてつてつてつてつてつてつてつて

梨壺 照陽宮 桐壺 休養宮 春壺 為時宮

梅壺 凝露宮 霜壺 雪宮

いまつてつてつてつてつてつてつて
 つてつてつてつてつてつてつてつて
 つてつてつてつてつてつてつてつて
 つてつてつてつてつてつてつてつて
 つてつてつてつてつてつてつてつて

Handwritten text in a cursive script, likely a letter or document. The text is written in a fluid, connected style across several lines. The ink is dark and the paper shows signs of age and wear.

Handwritten text in a cursive script, continuing from the previous page. The text is written in a fluid, connected style across several lines. The ink is dark and the paper shows signs of age and wear.

Handwritten text in Arabic script, top section of the left page.

Main body of handwritten text in Arabic script on the left page.

Handwritten text in Arabic script, bottom section of the left page.

Main body of handwritten text in Arabic script on the right page.

Handwritten text in Arabic script, bottom section of the right page.

Handwritten text in Arabic script, likely a religious or philosophical treatise. The text is written in a cursive style and spans the width of the page. It begins with a large initial letter 'ب' (Ba) and continues with several lines of text. The script is dense and fills most of the page area.

Handwritten text in Arabic script, continuing from the previous page. The text is written in a cursive style and spans the width of the page. It begins with a large initial letter 'ب' (Ba) and continues with several lines of text. The script is dense and fills most of the page area.

بسم الله الرحمن الرحيم
الحمد لله رب العالمين
والصلاة والسلام على
سيدنا محمد وآله الطيبين
الطاهرين

الذين أرسلناهم قبلك
مبينين لآياتنا
والعقوبات

فإنهم كانوا
على شفاهاة
من ربهم

فإنهم كانوا
على شفاهاة
من ربهم

فإنهم كانوا
على شفاهاة
من ربهم

فإنهم كانوا
على شفاهاة
من ربهم

فإنهم كانوا
على شفاهاة
من ربهم

فإنهم كانوا
على شفاهاة
من ربهم

فإنهم كانوا
على شفاهاة
من ربهم

فإنهم كانوا
على شفاهاة
من ربهم

فإنهم كانوا
على شفاهاة
من ربهم

فإنهم كانوا
على شفاهاة
من ربهم

Handwritten text in Arabic script, likely a religious or philosophical treatise. The text is densely packed and covers most of the page.

Handwritten text at the top of the page, possibly a title or a specific section header.

夕歌

Handwritten text below the section header, possibly a subtitle or a specific line of text.

Handwritten text in Arabic script, continuing the text from the previous page. It includes several lines of text with some larger characters or symbols.

~~~~~

~~~~~

~~~~~

~~~~~

~~~~~

~~~~~

~~~~~

~~~~~

~~~~~

~~~~~

~~~~~

~~~~~

~~~~~

~~~~~

~~~~~

~~~~~

~~~~~

~~~~~

~~~~~

~~~~~

~~~~~

~~~~~

~~~~~

~~~~~

あはれなる御心
御心よ

御心よ
御心よ

御心よ
御心よ

御心よ
御心よ

御心よ
御心よ

御心よ
御心よ

御心よ

あはれなる御心
御心よ

御心よ
御心よ

御心よ
御心よ

御心よ
御心よ

御心よ
御心よ

御心よ
御心よ

御心よ
御心よ

Handwritten text in Arabic script, consisting of approximately 12 lines of cursive script.

Handwritten text in Arabic script, consisting of approximately 12 lines of cursive script.

はらうし〜姫よ〜

わらわ〜

あ〜

末摘花

源七郎〜

はらうし〜

源の〜

源〜

ひら〜

源〜

あ〜

Handwritten text in cursive script, likely a letter or document fragment, located on the left page of the manuscript.

Handwritten text in cursive script, continuing from the left page or as a separate entry, located on the left page of the manuscript.

Handwritten text in cursive script, located on the right page of the manuscript, starting with a large initial character.

Handwritten text in cursive script, located on the right page of the manuscript, appearing as a distinct section or signature.

Handwritten text in cursive script, located on the right page of the manuscript, continuing the narrative or list.

年一とらね言はれし事して唯其のらるるにせし

あはれし事とてはるるにせし

あはれし事とてはるるにせし

あはれし事とてはるるにせし

原

あはれし事とてはるるにせし

鳥

あはれし事とてはるるにせし

あはれし事とてはるるにせし

あはれし事とてはるるにせし

あはれし事とてはるるにせし

あはれし事とてはるるにせし

あはれし事とてはるるにせし

あはれし事とてはるるにせし

あはれし事とてはるるにせし

あはれし事とてはるるにせし

あはれし事とてはるるにせし

あはれし事とてはるるにせし

あはれし事とてはるるにせし

あはれし事とてはるるにせし

あはれし事とてはるるにせし

あはれし事とてはるるにせし

あはれし事とてはるるにせし

あはれし事とてはるるにせし

あはれし事とてはるるにせし

あはれし事とてはるるにせし

あはれし事とてはるるにせし

お中ねえあゝいゝとてしらすりしむかにみゆきを
うらゝいほいんゝとてしらすりしむかにみゆきを
乃中ねえあゝいゝとてしらすりしむかにみゆきを
乃中ねえあゝいゝとてしらすりしむかにみゆきを
乃中ねえあゝいゝとてしらすりしむかにみゆきを
乃中ねえあゝいゝとてしらすりしむかにみゆきを

原
ゆはあゝいゝとてしらすりしむかにみゆきを
ゆはあゝいゝとてしらすりしむかにみゆきを
ゆはあゝいゝとてしらすりしむかにみゆきを
ゆはあゝいゝとてしらすりしむかにみゆきを

原
いゝとてしらすりしむかにみゆきを
いゝとてしらすりしむかにみゆきを
いゝとてしらすりしむかにみゆきを
いゝとてしらすりしむかにみゆきを

乃中ねえあゝいゝとてしらすりしむかにみゆきを
乃中ねえあゝいゝとてしらすりしむかにみゆきを
乃中ねえあゝいゝとてしらすりしむかにみゆきを
乃中ねえあゝいゝとてしらすりしむかにみゆきを

乃中ねえあゝいゝとてしらすりしむかにみゆきを
乃中ねえあゝいゝとてしらすりしむかにみゆきを
乃中ねえあゝいゝとてしらすりしむかにみゆきを
乃中ねえあゝいゝとてしらすりしむかにみゆきを

乃中ねえあゝいゝとてしらすりしむかにみゆきを
乃中ねえあゝいゝとてしらすりしむかにみゆきを
乃中ねえあゝいゝとてしらすりしむかにみゆきを
乃中ねえあゝいゝとてしらすりしむかにみゆきを

しらべりしころよもはりおきては世に...

ほ あつちのちかばらきかきけり
おのちのちかばらきかきけり
ま

春 源舟のうた

桐壺のくまのこまきとわたりてはし
ほすすしつりしよりのよりのよりの
唯そすまのちかばらきかきけり
あつちのちかばらきかきけり
ほすすしつりしよりのよりのよりの
ま

あつちのちかばらきかきけり
ま
あつちのちかばらきかきけり
ま

あつちのちかばらきかきけり
ま
あつちのちかばらきかきけり
ま

あはれい...
 い...
 て...
 ち...
 下...
 あ...
 母...
 あ...

え...
 神...
 神...

一...
 一...
 一...

一...
 一...
 一...

あはれ せむし せむし せむし せむし せむし せむし せむし

あはれ せむし せむし せむし せむし せむし せむし せむし せむし

あはれ せむし せむし せむし せむし せむし せむし せむし

あはれ せむし せむし せむし せむし せむし せむし せむし せむし

あはれ せむし せむし せむし せむし せむし せむし せむし せむし

あはれ せむし せむし せむし せむし せむし せむし せむし

柳

源左三十九月十九日

あはれ せむし せむし せむし せむし せむし せむし せむし

あはれ せむし せむし せむし せむし せむし せむし せむし

あはれ せむし せむし せむし せむし せむし せむし せむし

あはれ せむし せむし せむし せむし せむし せむし せむし

あはれ せむし せむし せむし せむし せむし せむし せむし

あはれ せむし せむし せむし せむし せむし せむし せむし

^{ソハト} ちいしはねのりやうに ちいしはねのりやうに

新よみかたのりやうに ちいしはねのりやうに

あまのりやうに ちいしはねのりやうに

あまのりやうに ちいしはねのりやうに

あまのりやうに ちいしはねのりやうに

あまのりやうに ちいしはねのりやうに

あまのりやうに ちいしはねのりやうに

あまのりやうに ちいしはねのりやうに

あまのりやうに ちいしはねのりやうに

あまのりやうに ちいしはねのりやうに

あまのりやうに ちいしはねのりやうに

^{ソハト} ちいしはねのりやうに ちいしはねのりやうに

新よみかたのりやうに ちいしはねのりやうに

あまのりやうに ちいしはねのりやうに

あまのりやうに ちいしはねのりやうに

あまのりやうに ちいしはねのりやうに

あまのりやうに ちいしはねのりやうに

あまのりやうに ちいしはねのりやうに

あまのりやうに ちいしはねのりやうに

あまのりやうに ちいしはねのりやうに

あまのりやうに ちいしはねのりやうに

あまのりやうに ちいしはねのりやうに

Handwritten text in Arabic script, likely a religious or philosophical treatise. The text is written in a cursive style and spans the width of the page. It begins with a small heading or initial letter on the left side. The script is dense and fills most of the page area.

Handwritten text in Arabic script, continuing from the previous page. The text is written in a cursive style and spans the width of the page. It begins with a small heading or initial letter on the left side. The script is dense and fills most of the page area.

新卒の中助
原
古

原
古
原
古
原
古

Handwritten text in Arabic script, top section of the left page.

Handwritten text in Arabic script, middle section of the left page.

Handwritten text in Arabic script, bottom section of the left page.

Handwritten text in Arabic script, top section of the right page.

Handwritten text in Arabic script, bottom section of the right page.

Handwritten text in Arabic script, consisting of approximately 15 lines of dense cursive writing.

Handwritten text in Arabic script, consisting of approximately 15 lines of dense cursive writing.

Handwritten text in a cursive script, likely a form of Arabic or Persian calligraphy, filling the left page of the manuscript.

Handwritten text in a cursive script, likely a form of Arabic or Persian calligraphy, filling the right page of the manuscript.

Handwritten text in a cursive script, likely a form of Arabic or Persian calligraphy, located at the bottom of the right page.

Handwritten text in a cursive script, likely a form of Arabic or Persian. The text is arranged in approximately 15 horizontal lines across the page. The ink is dark, and the paper shows signs of age and wear, including some staining and discoloration. The script is fluid and continuous, with some larger characters that may serve as section markers or initial letters.

Handwritten text in a cursive script, likely a form of Arabic or Persian. The text is arranged in approximately 15 horizontal lines across the page. The ink is dark, and the paper shows signs of age and wear, including some staining and discoloration. The script is fluid and continuous, with some larger characters that may serve as section markers or initial letters.

Handwritten text in Arabic script, likely a religious or philosophical treatise. The text is densely packed and covers most of the page. There are several lines of text, with some lines starting with a large initial letter. The script is cursive and characteristic of the Maghrebi or Andalusian style.

Handwritten text in Arabic script, continuing from the previous page. The text is densely packed and covers most of the page. There are several lines of text, with some lines starting with a large initial letter. The script is cursive and characteristic of the Maghrebi or Andalusian style.

Handwritten text in Arabic script, consisting of approximately 20 lines of dense, cursive writing.

Handwritten text in Arabic script, consisting of approximately 20 lines of dense, cursive writing.

Handwritten header or section title in Arabic script.

Handwritten text below the header, possibly a date or introductory phrase.

Handwritten text in Arabic script, consisting of approximately 10 lines of dense, cursive writing.

Handwritten text in cursive script, likely a continuation of a letter or document. The text is dense and fills most of the page.

繪合 源三郎 宛

Handwritten text in cursive script, continuing the message. The ink is dark and the characters are well-defined.

Handwritten text in cursive script, continuing the message. The text is written in a fluid, connected style.

圓金 宛

Handwritten text in cursive script, continuing the message. The text is written in a fluid, connected style.

Handwritten musical notation on the left page, consisting of several staves of notes and rests.

Handwritten musical notation on the left page, continuing the piece with various note values and rests.

Handwritten musical notation on the left page, featuring a treble clef and a key signature of one sharp (F#).

Handwritten musical notation on the left page, showing a continuation of the musical piece.

Handwritten musical notation on the right page, starting with a treble clef and a key signature of one sharp (F#).

Handwritten title or section header in the center of the right page.

Handwritten musical notation on the right page, continuing the piece with various note values and rests.

Handwritten text in Arabic script, consisting of approximately 15 lines of dense cursive writing.

Handwritten text in Arabic script, consisting of approximately 15 lines of dense cursive writing.

بِسْمِ اللَّهِ الرَّحْمَنِ الرَّحِيمِ

Handwritten text in Arabic script, consisting of approximately 15 lines of dense cursive writing.

Handwritten text in a cursive script, likely a continuation from the previous page.

Handwritten text in a cursive script, continuing the narrative or list.

明蝶 原

Handwritten text in a cursive script, possibly a list or a specific section.

Handwritten text in a cursive script, continuing the text on the right page.

Handwritten text in a cursive script, likely a letter or a page from a manuscript. The text is dense and fills most of the page.

Handwritten title or section header, possibly indicating the subject of the text.

Handwritten text in a cursive script, continuing the narrative or letter from the previous page.

Handwritten text in a cursive script, continuing the narrative or letter.

Handwritten text in a cursive script, continuing the narrative or letter.

Handwritten text in a cursive script, continuing the narrative or letter.

Handwritten text in cursive script, likely a preface or introductory section, starting with characters like '年' and '月'.

篝火

日女

Main body of handwritten text in cursive script, continuing the narrative or poem.

明佳妻

日女

Main body of handwritten text in cursive script, continuing the narrative or poem.

Handwritten text in a cursive script, likely a historical record or a letter. The text is densely packed and covers most of the page.

行幸源氏物語

Handwritten text in a cursive script, continuing the narrative or record from the previous page. It includes a large, stylized character '野' (no) in the middle.

Handwritten text at the bottom of the page, possibly a signature or a date.

Handwritten text in a cursive script, consisting of several lines of characters.

うた

うたのついでに

Main body of handwritten text in cursive script, occupying the right page.

Main body of handwritten text in cursive script, occupying the left page.

うた

うたのついでに

うた

Final section of handwritten text in cursive script at the bottom of the left page.

Handwritten text in Arabic script, top section of the left page.

Handwritten text in Arabic script, middle section of the left page.

Handwritten text in Arabic script, bottom section of the left page.

Handwritten text in Arabic script, top section of the right page.

Handwritten text in Arabic script, bottom section of the right page.

Handwritten text in Arabic script, top section of the left page.

Handwritten text in Arabic script, middle section of the left page.

Handwritten text in Arabic script, bottom section of the left page.

Handwritten text in Arabic script, narrow column on the left page.

Handwritten text in Arabic script, top section of the right page.

Handwritten title or section header in Arabic script.

Handwritten text in Arabic script, middle section of the right page.

Handwritten text in Arabic script, bottom section of the right page.

Handwritten text in Arabic script, likely a continuation from the previous page or a separate entry.

Handwritten title or section header in Arabic script, possibly indicating a specific chapter or topic.

Handwritten text in Arabic script, beginning with a large initial letter, possibly 'س' (S).

Handwritten text in Arabic script, continuing the narrative or list.

Handwritten text in Arabic script, featuring several lines of dense writing.

Handwritten text in Arabic script, including a large initial letter and several lines of text.

Handwritten text in Arabic script, concluding the page with several lines of text.

Handwritten text in the top left section of the left page.

Handwritten text in the middle left section of the left page.

Handwritten text in the bottom left section of the left page.

Handwritten text in the top right section of the left page.

Handwritten text in the middle right section of the left page.

Handwritten text in the bottom right section of the left page.

Handwritten text in the top left section of the right page.

Handwritten text in the middle left section of the right page.

Handwritten text in the bottom left section of the right page.

Handwritten text in the top right section of the right page.

Handwritten text in a cursive script, likely a list or account. The text is arranged in several columns, with some lines starting with small characters that may be initials or section markers. The ink is dark and the paper shows signs of age.

Handwritten text in a cursive script, continuing the list or account from the previous page. The lines are closely spaced and the script is consistent throughout.

Handwritten text in a cursive script, possibly a continuation or a separate entry. The text is written in a similar style to the other pages.

Handwritten text in a cursive script, occupying the right page of the spread. The text is dense and fills most of the page, with some larger characters interspersed.

Handwritten text in Arabic script, likely a religious or philosophical treatise. The text is densely packed and covers most of the page. It begins with a small heading or initial line, followed by several paragraphs of continuous writing. The script is clear and consistent throughout the page.

Handwritten text in Arabic script, continuing from the previous page. The text is densely packed and covers most of the page. It begins with a small heading or initial line, followed by several paragraphs of continuous writing. The script is clear and consistent throughout the page.

Handwritten text in cursive script, likely a chapter or section header, possibly starting with '幻' (Illusion).

幻

源女十ニテ

Handwritten text block, possibly a list or a specific section of the manuscript.

Handwritten text block, continuing the narrative or list.

Handwritten text block, continuing the narrative or list.

源女十ニテ

Handwritten text block, continuing the narrative or list.

Handwritten text block, continuing the narrative or list.

Handwritten text in Arabic script, likely a religious or philosophical treatise. The text is arranged in approximately 12 vertical columns, reading from right to left. The script is a cursive style, possibly Maghrebi or Maghribi. There are several lines of text that appear to be headings or section markers, some starting with large, decorative initial letters. The paper shows signs of age, including some staining and discoloration.

Handwritten text in Arabic script, continuing from the previous page. It consists of approximately 12 vertical columns of text, reading from right to left. The script is consistent with the previous page. There are some lines of text that appear to be headings or section markers. The paper shows signs of age, including some staining and discoloration.

Handwritten text in a cursive style, likely a letter or a short story. The text is dense and fills most of the page.

あはれ

Handwritten text in a cursive style, continuing from the previous page. It includes a large section header 'あはれ' and several lines of text.

あはれ

あはれ

Handwritten text in cursive script, likely a preface or introductory section. The text is dense and fills most of the page.

作年

Handwritten text in cursive script, continuing the narrative or providing details. The script is consistent with the first page.

Handwritten text in cursive script, occupying the right page of the manuscript. The text appears to be a continuation of the previous page.

Handwritten text in a cursive script, likely a historical document or manuscript. The text is densely packed and covers most of the page.

Handwritten text in a cursive script, continuing from the previous page. The text is densely packed and covers most of the page.

Handwritten text in Arabic script, likely a continuation of a letter or a chapter section. The text is dense and fills most of the page.

Handwritten text in Arabic script, continuing from the previous page. It includes a section with the heading "自便" (Zi-bian) written in large, bold characters.

Handwritten text at the bottom of the right page, possibly a signature or a concluding note.

Handwritten text in Arabic script, likely a preface or introductory section, located at the top of the left page.

بِسْمِ اللَّهِ الرَّحْمَنِ الرَّحِيمِ

Main body of handwritten text in Arabic script on the left page, continuing the narrative or discourse.

Main body of handwritten text in Arabic script on the right page, continuing the narrative or discourse.

Handwritten text in Arabic script, consisting of several lines of dense cursive writing.

Chapter 4

Handwritten text in Arabic script, continuing from the previous page.

Handwritten text in Arabic script, continuing from the previous page.

東卷 卷之八 八九月 初平

Handwritten musical notation on the left page, consisting of a single melodic line with various rhythmic values and accidentals.

Handwritten musical notation on the right page, consisting of a single melodic line with various rhythmic values and accidentals.

Handwritten text in Arabic script, consisting of approximately 15 lines of dense cursive writing.

Handwritten title or section header in Arabic script, centered on the page.

Handwritten text in Arabic script, consisting of approximately 10 lines of dense cursive writing.

Handwritten text in Arabic script, consisting of approximately 10 lines of dense cursive writing.

Handwritten text in Arabic script, consisting of approximately 10 lines of dense cursive writing.

Handwritten text in Arabic script, consisting of approximately 10 lines of dense cursive writing.

Handwritten text in Arabic script, consisting of approximately 10 lines of dense cursive writing.

Handwritten text in Arabic script, consisting of approximately 15 lines of dense cursive writing.

Handwritten header or section title in Arabic script, possibly starting with 'بسم الله'.

Handwritten text in Arabic script, continuing from the previous page with approximately 15 lines of dense cursive writing.

Handwritten text in Arabic script, consisting of approximately 10 lines of dense cursive writing.

Handwritten text in Arabic script, consisting of approximately 15 lines of dense cursive writing, filling the right page.

Handwritten text in a cursive script, likely a letter or a personal note. The text is dense and fills most of the page.

Handwritten text at the bottom of the left page, possibly a signature or a closing phrase.

Vertical title or section header written in a stylized cursive script.

Handwritten text on the right page, continuing the narrative or letter. It includes several lines of cursive script.

Handwritten text at the top left of the left page.

Handwritten text in the middle left of the left page.

Handwritten text in the middle left of the left page.

Main body of handwritten text on the left page, consisting of several lines of cursive script.

Main body of handwritten text on the right page, consisting of several lines of cursive script.

Handwritten text in a cursive script, likely a continuation of a letter or a personal note. The ink is dark and the paper shows signs of age and wear.

手紙

蓮舟

蓮舟

Main body of handwritten text on the left page, continuing the narrative or message. The script is consistent with the rest of the document.

Main body of handwritten text on the right page, concluding the message or letter. The text is dense and fills most of the page.

Handwritten Japanese text in cursive style (sōsho), covering both pages of the manuscript. The text is densely packed and flows across the lines of the pages.

24
25

Handwritten notes on the right margin of the right page, including the characters '六條院'.

六條院

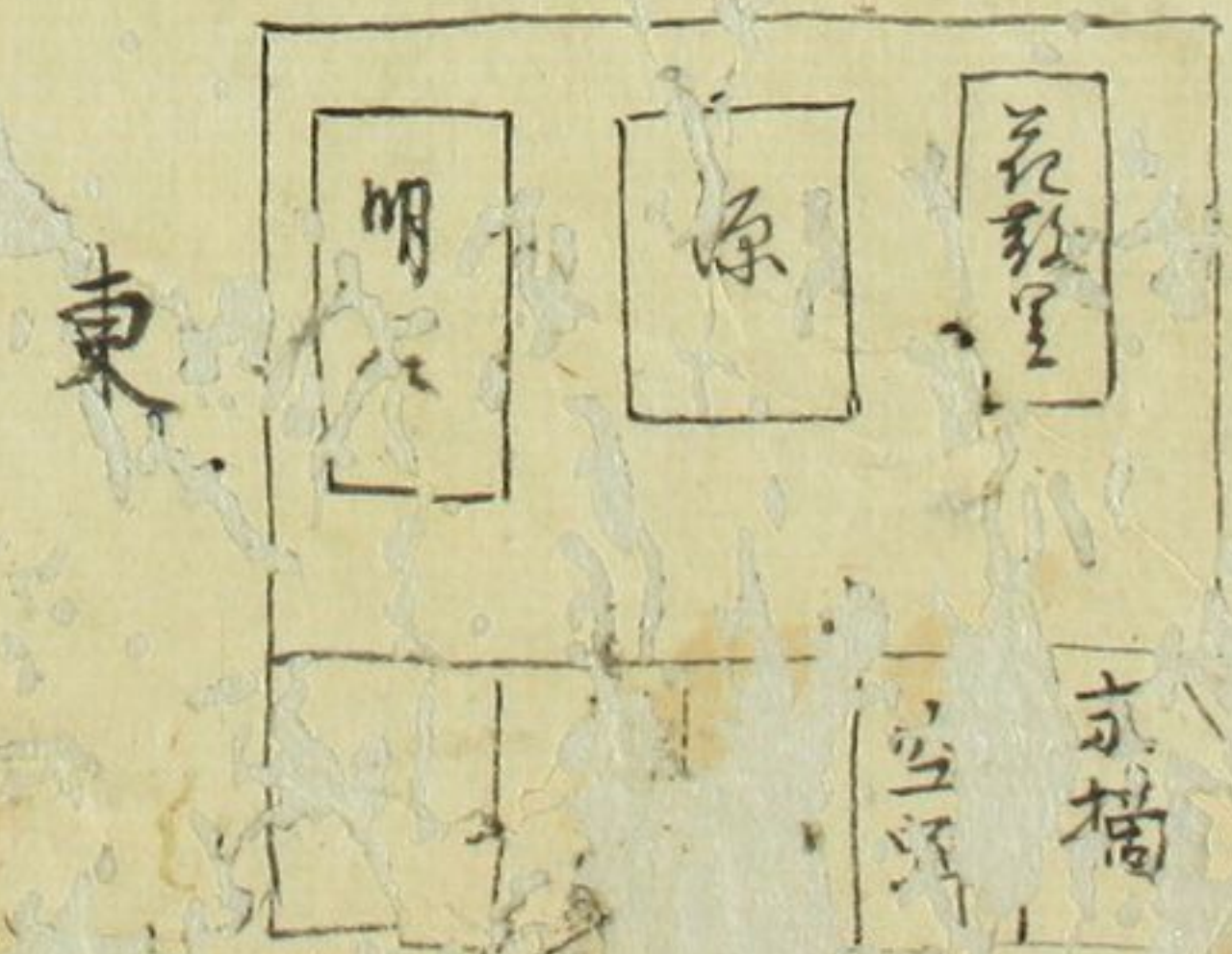
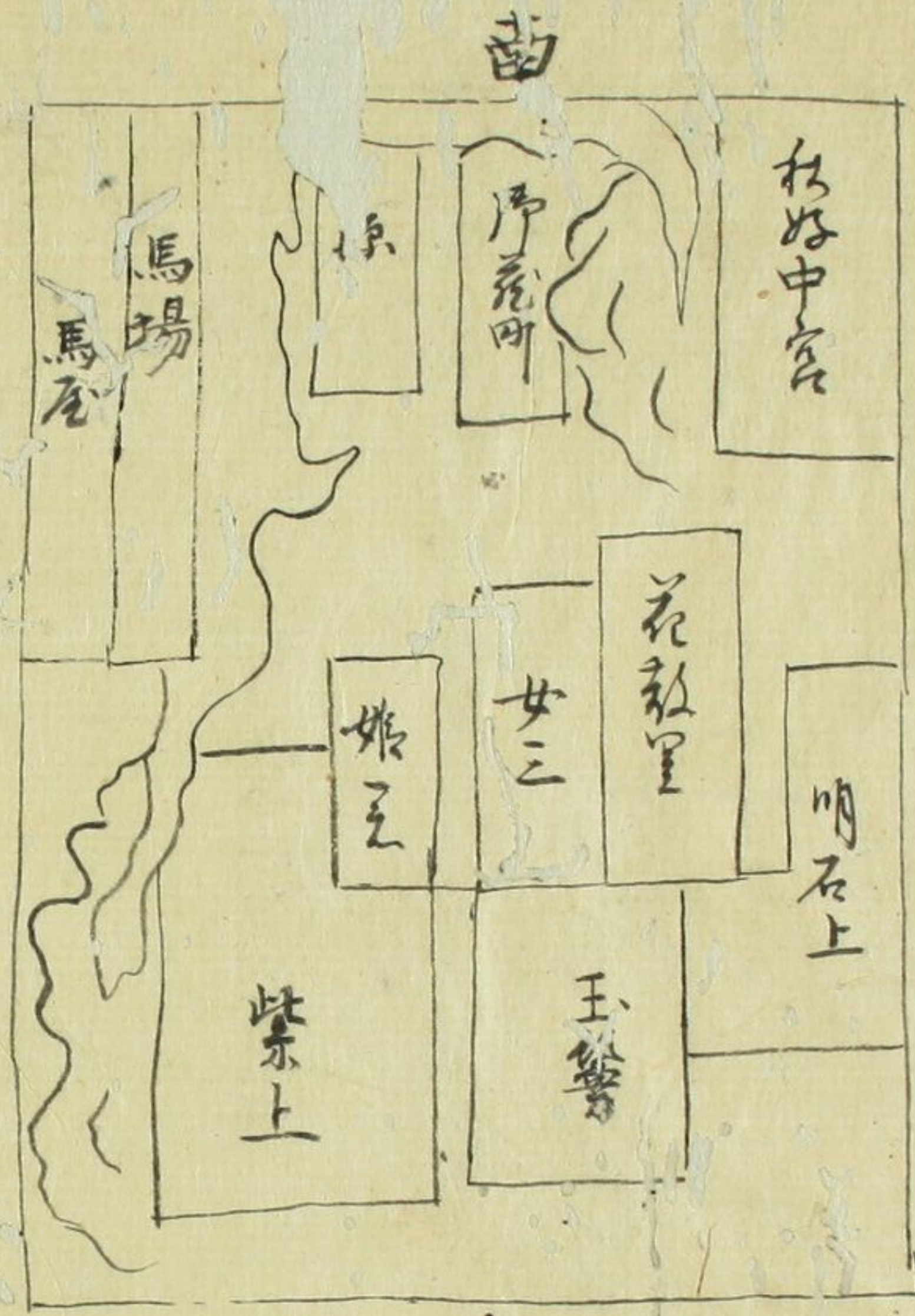

太上天皇

桐玉御所

前坊

秋好中宮

母六條所休取

桃園式部卿宮權齊院

三宮

女五宮

朱雀院

母弘徽殿惡后

今上

母美香殿

女一宮

落葉宮

母一条息取

二品内親王

女三

女四宮

春宮

母明石上

式部卿宮

白兵部卿宮

右君 母 中君

常陸

一品

女二宮

六條院 母初壹

兼左大臣 母葵上

中納言

薰大將 母女三宮

右大臣

管兵部御宮

重宮

侍從宰相

四宮 母兼香御

同 宮御方 母真大任上

源宰相 母中將 母內侍

帥宮

角總大君 母大臣

頭中將 母內侍

八宮 母大臣

中君 母大臣

四位少將 母內侍

三君 母

童 母

式部御宮

侍從

春宮 母御 三條

宮君

中君 母御 三條

冷泉院

一宮 母致任大臣

四君 母御 三條

一品宮 母生教世

女一宮 母致任大臣

五君 母御 三條

女二宮 母齊院

女二宮 母二宮

六君 母御 三條

先帝

式部御宮

源守 母御 三條

薄雲女院

中將 母御 三條

源氏宮

侍從 母御 三條

常陸宮

阿爾梨

民部大輔 母御 三條

蓬生君

此上 母御 三條

柏木權大納言

冷泉院女御 母御 三條

紅梅右大臣

大夫 母御 三條

左衛門督

廉景殿女御 母御 三條

藤宰相

中 母御 三條

頭中將

中 母御 三條

藏人少將

中 母御 三條

八郎君

中 母御 三條

玉鬘勞曲侍 母葵上

中 母御 三條

弘徽殿女御

中 母御 三條

露大臣

攝政太政大臣

致仕太政大臣

左中辨

藤大納言

春宮大吏

葵上

左大臣

女御

按察大納言

小山僧都

紫上母

二條太政大臣

藤大納言

四位少將

左中辨

弘徽殿太后

帥宮北心

致仕大臣室

五君

藤月夜尚侍

江君

左大臣

文藏

修理大夫

女子

藤大納言

竹川左大臣

女

大臣

女御

大臣

六條御休取

大臣

前攝磨守入道

明石上

按察大納言

雲林院律師

桐壺更衣

右大臣

藤原大政大臣

頭中將

兼香殿女御

左衛門佐

空輝君

三位中將

夕顔上

宰相

宰相君

右衛門督

小邸君

藤中納言

次郎君

右兵衛督

右大臣

頭中將

直上

女御

尚侍

伊豫介

太宰大貳

統帥

紀伊守

藏人右近將監

藏人少將妻

太宰少貳

參議藤原惟光

兵衛尉

豐後介

山阿耨梨

藤曲侍

次郎

少將命婦

三河守妻

前播磨守

三郎

常陸介

源義清

揚名介妻

藏人式部丞

藏人右近將監

參議宮内卿 明石守

童

源少統言妻

讀波守妻

少將北方



